

LEGEND

- BOUNDARY
- HERITAGE INDIVIDUALLY SIGNIFICANCE
- HERITAGE CONTRIBUTORY SIGNIFICANCE
- VEHICLE CROSSING
- V VEHICULAR ACCESS
- P PEDESTRIAN ACCESS
- EXISTING FENCE
- EXISTING WASTE STORAGE AREA REFER TO WASTE MANAGEMENT PLAN FOR DETAIL

7	REVISED FOR DEVELOPMENT APPLICATION	22.05.2018
6	REVISED FOR DEVELOPMENT APPLICATION	26.04.2018
5	REVISED FOR DEVELOPMENT APPLICATION	18.04.2018
4	TREE NUMBERS ADDED	06.04.2018
3	REVISED FOR DEVELOPMENT APPLICATION	09.11.2017
2	DEVELOPMENT APPLICATION	07.11.2017
1	DRAFT DEVELOPMENT APPLICATION	24.10.2017
Rev	Description	Date

DEVELOPMENT APPLICATION

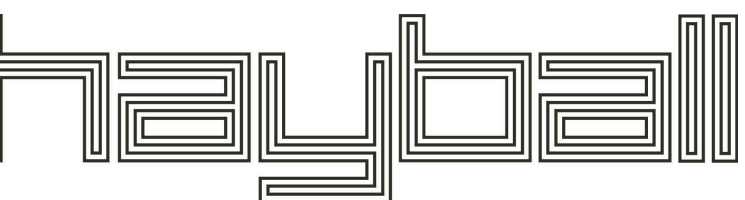

Melbourne  
4/135 Sturt Street Southbank, Victoria Australia 3006  
T 0+61 3 9699 3644  
www.hayball.com.au

Sydney  
7/1/26-32 Pirrama Road, Pyrmont NSW 2009  
T +61 2 9660 9329

Brisbane  
Level 12, 324 Queen Street, Brisbane Qld 4000  
T +61 7 3211 9821

NSW Nominated Architects:  
Tom Jordan 7521, Richard Leonard 7522, David Tordoff 8028  
ABN 84 006 394 261

Builders/Contractors shall verify job dimensions before any job commences. Figured dimensions shall take precedence over scaled work. Work shall also conform to the specification, other drawings and job dimensions. All shop drawings shall be submitted to the Architect/Consultant and manufacturers shall not commence prior to the return of inspected shop drawings signed by the Architect/Consultant. © Copyright 2008 All rights reserved.

Client:



67A Church Street, WOLLONGONG, NSW

DRAWING TITLE  
SITE ANALYSIS PLAN

DRAWN BY VC  
CHECKED RC  
DATE PRINTED 22/05/2018 11:16:53 AM  
SCALE 1: 500@A1 1:1000@A3

PROJECT NUMBER DWG NO REVISION  
2141.10 DA00.01 7





- LEGEND**
- BOUNDARY
  - EXISTING
  - EXISTING TO BE DEMOLISHED
  - VEHICLE CROSSING
  - VEHICULAR ACCESS
  - PEDESTRIAN ACCESS
  - TREE TO BE REMOVED
  - EXISTING RAINWATER AND HYDRAULIC EQUIPMENT TO BE RELOCATED BY CONTRACTOR DURING CONSTRUCTION. CONTRACTOR TO DEMOLISH ANY SUPPORT PAD, PAVING, REDUNDANT CONCRETE PATHWAYS, RECOVER REDUNDANT SERVICES, AND MAKE GOOD AREA WITH TURF
  - EXISTING FENCE
  - EXISTING WASTE STORAGE AREA REFER TO WASTE MANAGEMENT PLAN FOR DETAIL
  - EXISTING DEMOUNTABLES

6	REVISED FOR DEVELOPMENT APPLICATION	22.05.2018
5	REVISED FOR DEVELOPMENT APPLICATION	26.04.2018
4	REVISED FOR DEVELOPMENT APPLICATION	18.04.2018
3	REVISED FOR DEVELOPMENT APPLICATION	09.11.2017
2	DEVELOPMENT APPLICATION	07.11.2017
1	DRAFT DEVELOPMENT APPLICATION	24.10.2017
Rev	Description	Date

DEVELOPMENT APPLICATION

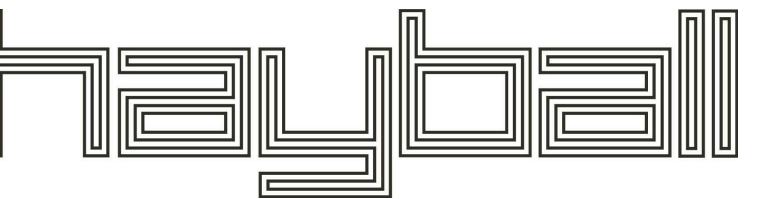

**Melbourne**  
4/135 Sturt Street Southbank, Victoria Australia 3006  
T 0+61 3 9699 3644  
www.hayball.com.au

**Sydney**  
7/1 26-32 Pirrama Road, Pyrmont NSW 2009  
T +61 2 9660 9329

**Brisbane**  
Level 12, 324 Queen Street, Brisbane Qld 4000  
T +61 7 3211 9821

**NSW Nominated Architects:**  
Tom Jordan 7521, Richard Leonard 7522, David Tordoff 8028  
ABN 84 006 394 261

Buildings/Contractors shall verify job dimensions before any job commences. Figured dimensions shall take precedence over scaled work. Work shall also conform to the specification, other drawings and job dimensions. All shop drawings shall be submitted to the Architect/Consultant and manufacturers shall not commence prior to the return of inspected shop drawings signed by the Architect/Consultant. © Copyright 2008 All rights reserved.



67A Church Street, WOLLONGONG, NSW

DRAWING TITLE  
**SITE PLAN EXISTING AND DEMOLITION**  
DRAWN BY VC  
CHECKED RC  
DATE PRINTED 22/05/2018 11:16:56 AM  
SCALE 1: 500@A1 1:1000@A3

PROJECT NUMBER	DWG NO	REVISION
2141.10	DA01.01	6



TREES TO BE REMOVED NOT SHOWN ON PROPOSED  
PLAN FOR CLARITY. REFER TO SITE PLAN - EXISTING  
& DEMOLITION

INDICATIVE PROPOSED LOCATION  
FOR NEW PICK-UP / DROP-OFF  
ZONE

NEW SECURE FENCE AND GATE -  
GATE-04

— PROPOSED NEW OSD TANK. REFER TO  
STORMWATER MANAGEMENT PLAN

PROPOSED NEW LEARNING BUILDING. 11  
STUDIO SPACES. 2 LEVELS. REFER TO B10  
SERIES.

— PROPOSED NEW COLA. REFER TO B10  
SERIES

— EXISTING RAINWATER TANK TO REMAIN

PROPOSED REFURBISHMENT WORKS FOR  
NEW TOILET BLOCK. REFER TO A10 SERIES

— ZONE FOR ADDITIONAL BICYCLE PARKING  
INDICATIVE LOCATION  
REFER TO TRAFFIC REPORT

— • — BOUNDARY

EXISTING

## PROPOSED NEW WORKS

 PROPOSED REFURBISHMENT WORKS

VEHICLE CROSSING

— EXISTING FENCE

EXISTING WASTE STORAGE AREA REFER TO WASTE MANAGEMENT PLAN FOR DETAIL



RELOCATED RAINWATER AND HYDRAULIC EQUIPMENT.  
REFER TO STORMWATER MANAGEMENT PLAN

**NEW TREE**

— . — LANDSCAPING ZONE. REFER TO LANDSCAPE DRAWINGS FOR DETAIL

DEVELOPMENT APPLICATION

# huybali

**Melbourne**  
4/135 Sturt Street Southbank, Victoria Australia 3006  
T 0+61 3 9699 3644  
[www.hayball.com.au](http://www.hayball.com.au)

**Sydney**  
71/ 26-32 Pirrama Road, Pyrmont NSW 2009  
T +61 2 9660 9329

**Brisbane**  
Level 12, 324 Queen Street, Brisbane Qld 4000  
T +61 7 3211 9821

**NSW Nominated Architects:**  
Tom Jordan 7521, Richard Leonard 7522, David Tordoff 8028  
ABN 84 006 394 261

Builders/Contractors shall verify job dimensions before any job commences. Figured dimensions shall take precedence over scaled work. Work shall also conform to the specification, other drawings and job dimensions. All shop drawings shall be submitted to the Architect/Consultant and manufacture shall not commence prior to the return of inspected shop drawings signed by the Architect/Consultant. © Copyright 2008 All rights reserved

Client:



**Wollongong Public School**

67A Church Street, WOLLONGONG, NSW

DRAWING TITLE  
**SITE PLAN PROPOSED**

DRAWN BY VC  
CHECKED RC  
DATE PRINTED 22/05/2018 11:16:59 AM  
SCALE 1 : 500@A1 1:1000@A3

PROJECT NUMBER	DWG NO	REVISION
----------------	--------	----------

**2141.10            DA01.05    7**





CUT TO MAKE AN ACCESSIBLE  
RAMP AT SLOPE 1:14. REFER TO  
LANDSCAPE ARCHITECT DRAWINGS  
FOR DETAIL



- LEGEND
- FILL
  - CUT
  - RETAINING WALL

4	REVISED FOR DEVELOPMENT APPLICATION	22.05.2018
3	REVISED FOR DEVELOPMENT APPLICATION	09.11.2017
2	DEVELOPMENT APPLICATION	07.11.2017
1	DRAFT DEVELOPMENT APPLICATION	24.10.2017
Rev	Description	Date

## DEVELOPMENT APPLICATION

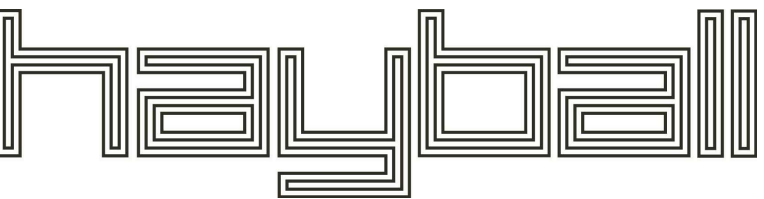

**Melbourne**  
4/135 Sturt Street Southbank, Victoria Australia 3006  
T 0+61 3 9699 3644  
www.hayball.com.au

**Sydney**  
71/ 26-32 Pirrama Road, Pyrmont NSW 2009  
T +61 2 9660 9329

**Brisbane**  
Level 12, 324 Queen Street, Brisbane Qld 4000  
T +61 7 3211 9821

**NSW Nominated Architects:**  
Tom Jordan 7521, Richard Leonard 7522, David Tordoff 8028  
ABN 84 006 394 261

Buildings/Contractors shall verify job dimensions before any job commences. Figured dimensions shall take precedence over scaled work. Work shall also conform to the specification, other drawings and job dimensions. All shop drawings shall be submitted to the Architect/Consultant and manufacturers shall not commence prior to the return of inspected shop drawings signed by the Architect/Consultant. © Copyright 2008 All rights reserved.

Client:



67A Church Street, WOLLONGONG, NSW

DRAWING TITLE  
**SITE PLAN CUT AND FILL**

DRAWN BY VC  
CHECKED RC  
DATE PRINTED 22/05/2018 11:17:03 AM  
SCALE 1 : 500@A1 1:1000@A3



PROJECT NUMBER DWG NO REVISION  
**2141.10 DA01.06 4**





**DEMOUNTABLES**

EXISTING DEMOUNTABLES

NEW DEMOUNTABLES

**NOTE:** INSTALLATION OF DEMOUNTABLES INCLUDING ASSOCIATED SERVICES, FOOTPATHS AND WALKWAYS BY OTHERS UNDER EXEMPT DEVELOPMENT SEPP

REMOVAL OF DEMOUNTABLES INCLUDING DEMOLITION OF PIERS, WALKWAYS, FOOTPATHS, SERVICE CAPPING BY OTHERS UNDER EXEMPT DEVELOPMENT SEPP

CONTRACTOR TO MAKE GOOD AREA WITH TURF AFTER DEMOUNTABLE REMOVAL BY OTHERS

1	FOR INFORMATION ONLY	01.05.2018
Rev	Description	Date

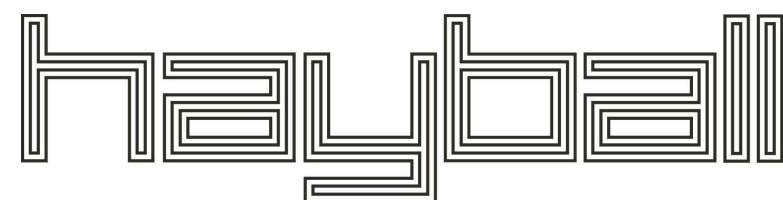

**Melbourne**  
4/135 Sturt Street Southbank, Victoria Australia 3006  
T 0+61 3 9699 3644  
www.hayball.com.au

**Sydney**  
71/ 26-32 Pirrama Road, Pyrmont NSW 2009  
T +61 2 9660 9329

**Brisbane**  
Level 12, 324 Queen Street, Brisbane Qld 4000  
T +61 7 3211 9821

**NSW Nominated Architects:**  
Tom Jordan 7521, Richard Leonard 7522, David Tordoff 8028  
ABN 84 006 394 261

Builders/Contractors shall verify job dimensions before any job commences. Figured dimensions shall take precedence over scaled work. Work shall also conform to the specification, other drawings and job dimensions. All shop drawings shall be submitted to the Architect/Consultant and manufacturers shall not commence prior to the return of inspected shop drawings signed by the Architect/Consultant. © Copyright 2008 All rights reserved.

Client:



67A Church Street, WOLLONGONG, NSW

DRAWING TITLE  
**EXEMPT DEVELOPMENT SITE PLAN**

DRAWN BY VC  
CHECKED RC  
DATE PRINTED 3/05/2018 3:46:10 PM  
SCALE 1 : 500@A1



PROJECT NUMBER DWG NO REVISION  
**2141.10 DA02.01 1**



- NOTES:
1. AUDIT ALL HAZARDOUS MATERIALS INCLUDING BUT NOT LIMITED TO THOSE LISTED IN HAZMAT REPORT.
  2. REMOVE CAREFULLY AS PER HAZMAT REPORT AND ARCHITECTURAL SPECIFICATION. REINSTATE WITH SUITABLE NEW MATERIALS.

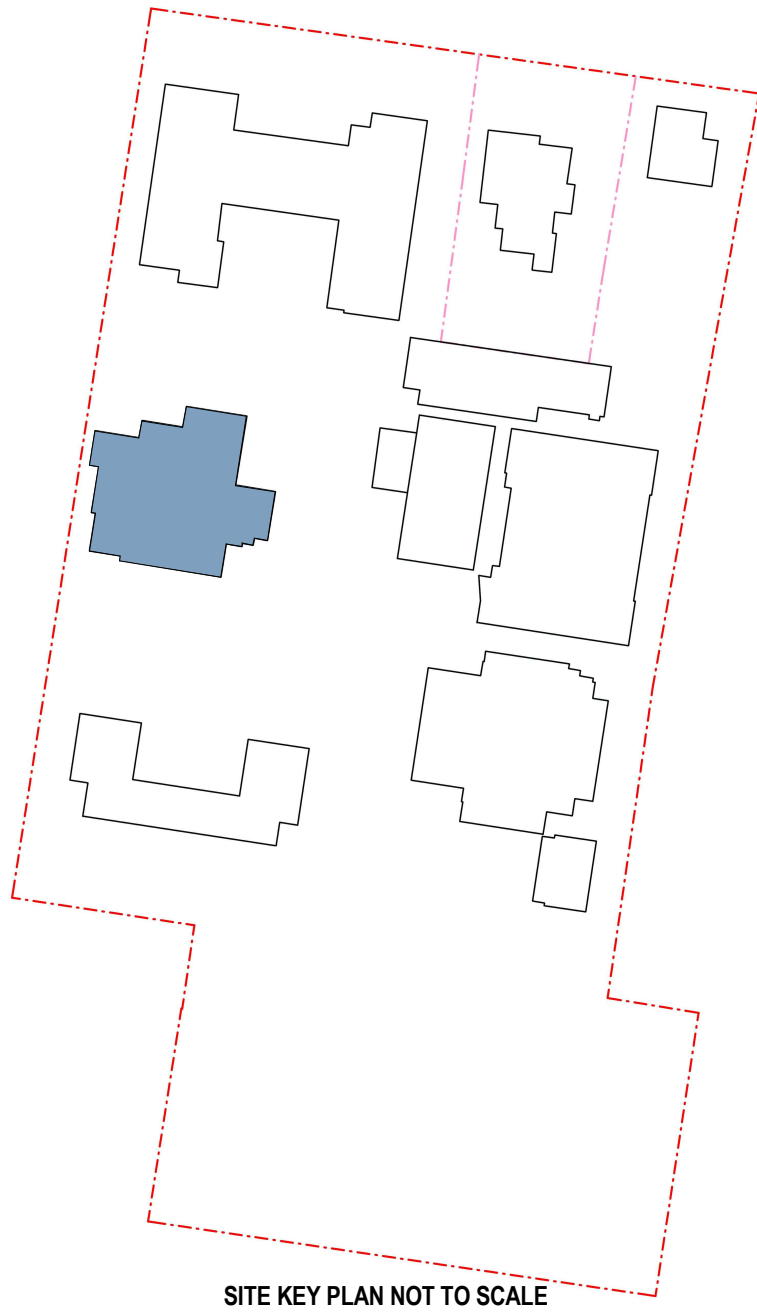

- LEGEND
- BOUNDNARY
  - EXISTING TO BE DEMOLISHED

4	REVISED FOR DEVELOPMENT APPLICATION	18.04.2018
3	REVISED FOR DEVELOPMENT APPLICATION	09.11.2017
2	DEVELOPMENT APPLICATION	07.11.2017
1	DRAFT DEVELOPMENT APPLICATION	24.10.2017
Rev	Description	Date

## DEVELOPMENT APPLICATION

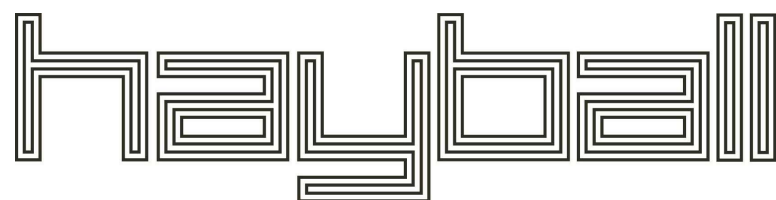

**Melbourne**  
4/135 Sturt Street Southbank, Victoria Australia 3006  
T 0+61 3 9699 3644  
www.hayball.com.au

**Sydney**  
7/1/26-32 Pirrama Road, Pyrmont NSW 2009  
T +61 2 9660 9329

**Brisbane**  
Level 12, 324 Queen Street, Brisbane Qld 4000  
T +61 7 3211 9821

**NSW Nominated Architects:**  
Tom Jordan 7521, Richard Leonard 7522, David Tordoff 8028  
ABN 84 006 394 261

Builders/Contractors shall verify job dimensions before any job commences. Figured dimensions shall take precedence over scaled work. Work shall also conform to the specification, other drawings and job dimensions. All shop drawings shall be submitted to the Architect/Consultant and manufacturer shall not commence prior to the return of inspected shop drawings signed by the Architect/Consultant. © Copyright 2008 All rights reserved.

Client:



**Wollongong Public School**

67A Church Street, Wollongong, NSW 2500

DRAWING TITLE  
**EXISTING AND DEMOLITION PLAN**

DRAWN BY VC  
CHECKED RC  
DATE PRINTED 18/04/2018 9:43:54 AM  
SCALE 1 : 100@A1 1:200@A3



PROJECT NUMBER DWG NO REVISION

**2141.10 A10.DA01.10 4**

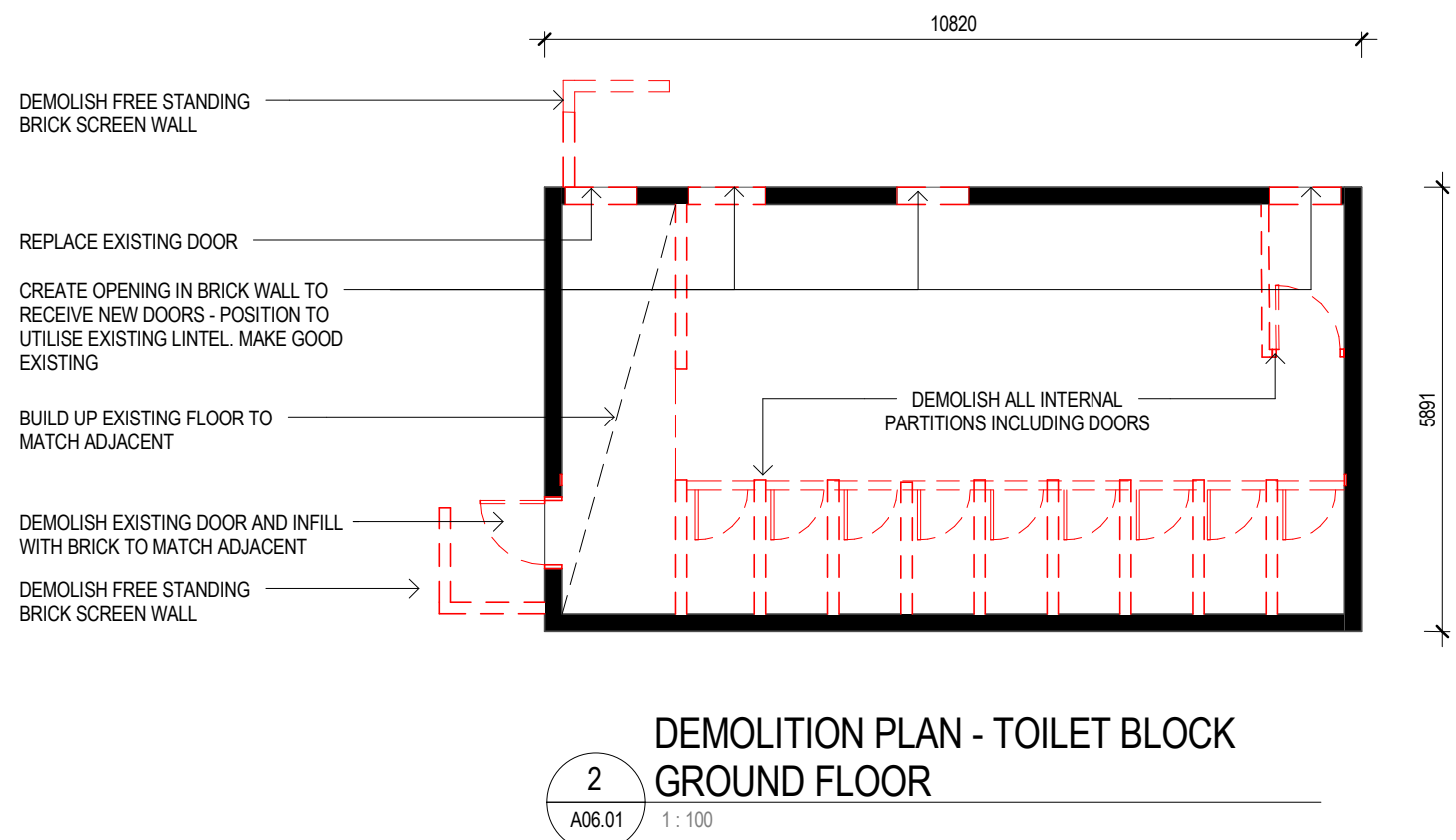
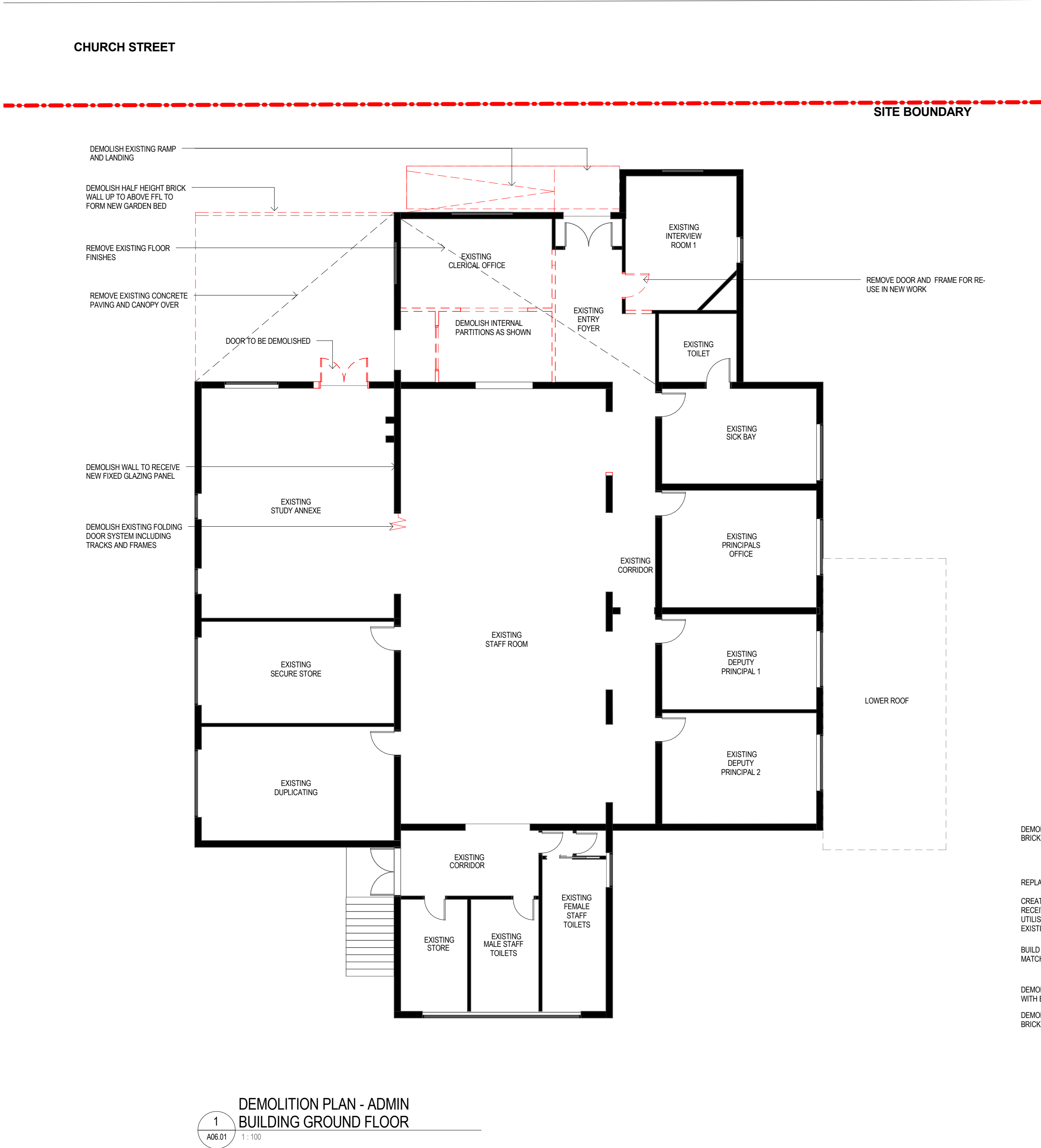



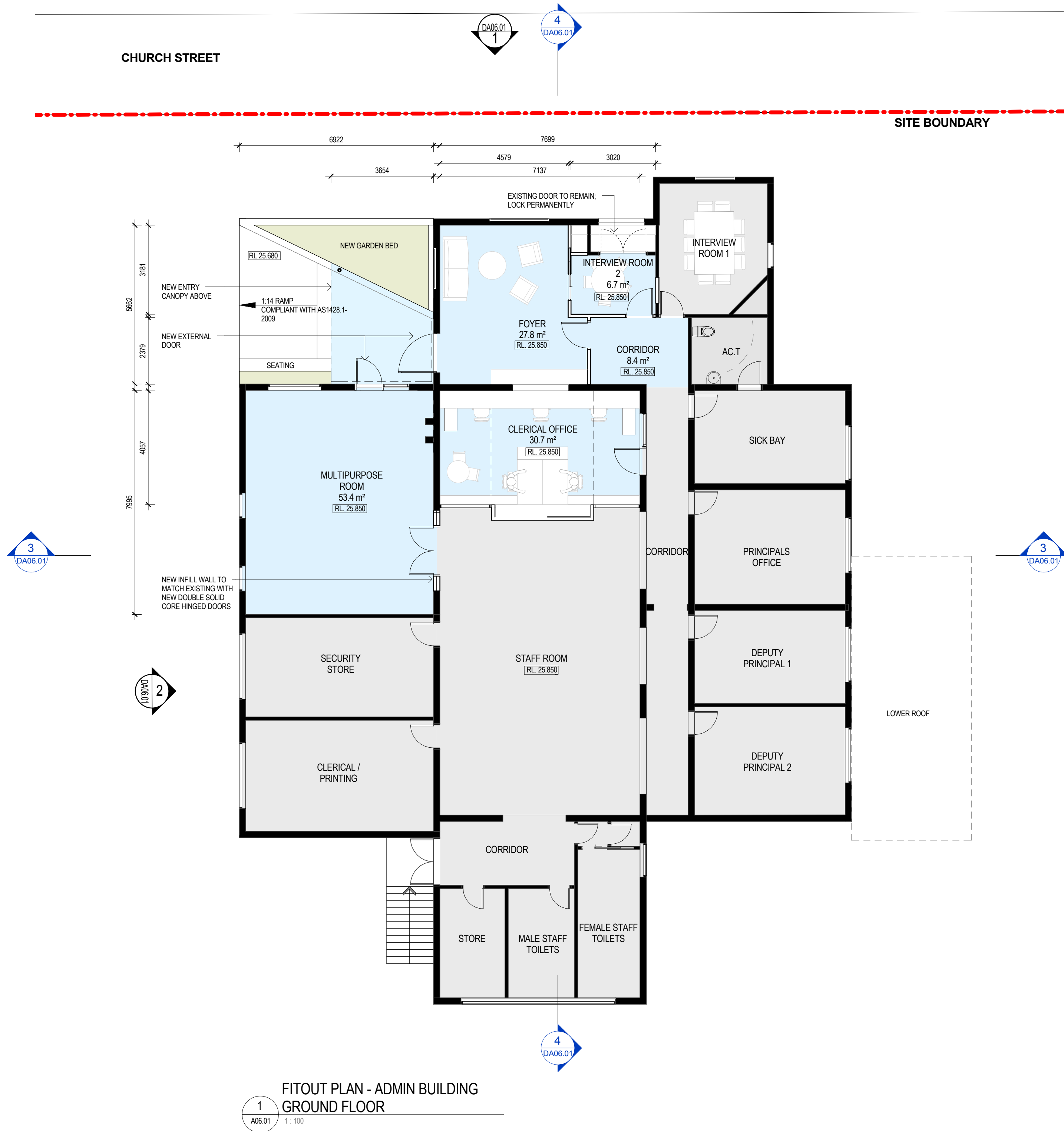

NOTES:

1. AUDIT ALL HAZARDOUS MATERIALS INCLUDING BUT NOT LIMITED TO THOSE LISTED IN HAZMAT REPORT.

2. REMOVE CAREFULLY AS PER HAZMAT REPORT AND ARCHITECTURAL SPECIFICATION. REINSTATE WITH SUITABLE NEW MATERIALS.

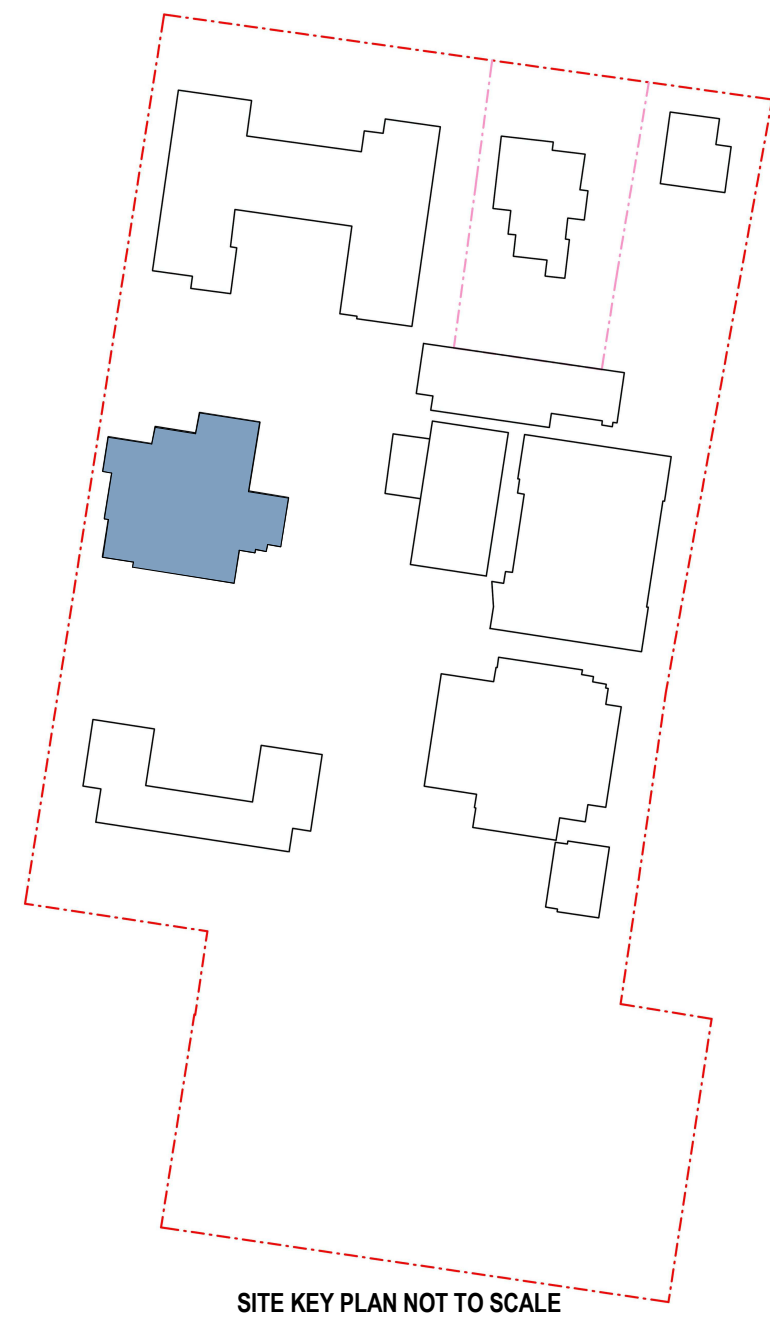

LEGEND

- BOUNDNARY
- EXISTING AREA
- PROPOSED REFURBISHMENT WORKS

4	REVISED FOR DEVELOPMENT APPLICATION	18.04.2018
3	REVISED FOR DEVELOPMENT APPLICATION	09.11.2017
2	DEVELOPMENT APPLICATION	07.11.2017
1	DRAFT DEVELOPMENT APPLICATION	24.10.2017
Rev	Description	Date

DEVELOPMENT APPLICATION

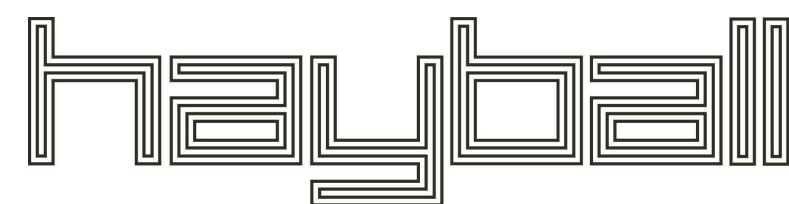

**Melbourne**  
4/135 Sturt Street Southbank, Victoria Australia 3006  
T +61 3 9699 3644  
www.hayball.com.au

**Sydney**  
7/1/26-32 Pirrama Road, Pyrmont NSW 2009  
T +61 2 9660 9329

**Brisbane**  
Level 12, 324 Queen Street, Brisbane Qld 4000  
T +61 7 3211 9821

**NSW Nominated Architects:**  
Tom Jordan 7521, Richard Leonard 7522, David Tordoff 8028  
ABN 84 006 394 261

Builders/Contractors shall verify job dimensions before any job commences. Figured dimensions shall take precedence over scaled work. Work shall also conform to the specification, other drawings and job dimensions. All shop drawings shall be submitted to the Architect/Consultant and manufactured shall not commence prior to the return of inspected shop drawings signed by the Architect/Consultant. © Copyright 2008 All rights reserved

Client:



Wollongong Public School

BLOCK B, H

67A Church Street, Wollongong, NSW 2500

DRAWING TITLE  
**PROPOSED GROUND FLOOR**

DRAWN BY VC  
CHECKED RC  
DATE PRINTED 18/04/2018 9:44:00 AM  
SCALE 1:100@A1 1:200@A3

PROJECT NUMBER DWG NO REVISION

**2141.10 A10.DA03.01 4**

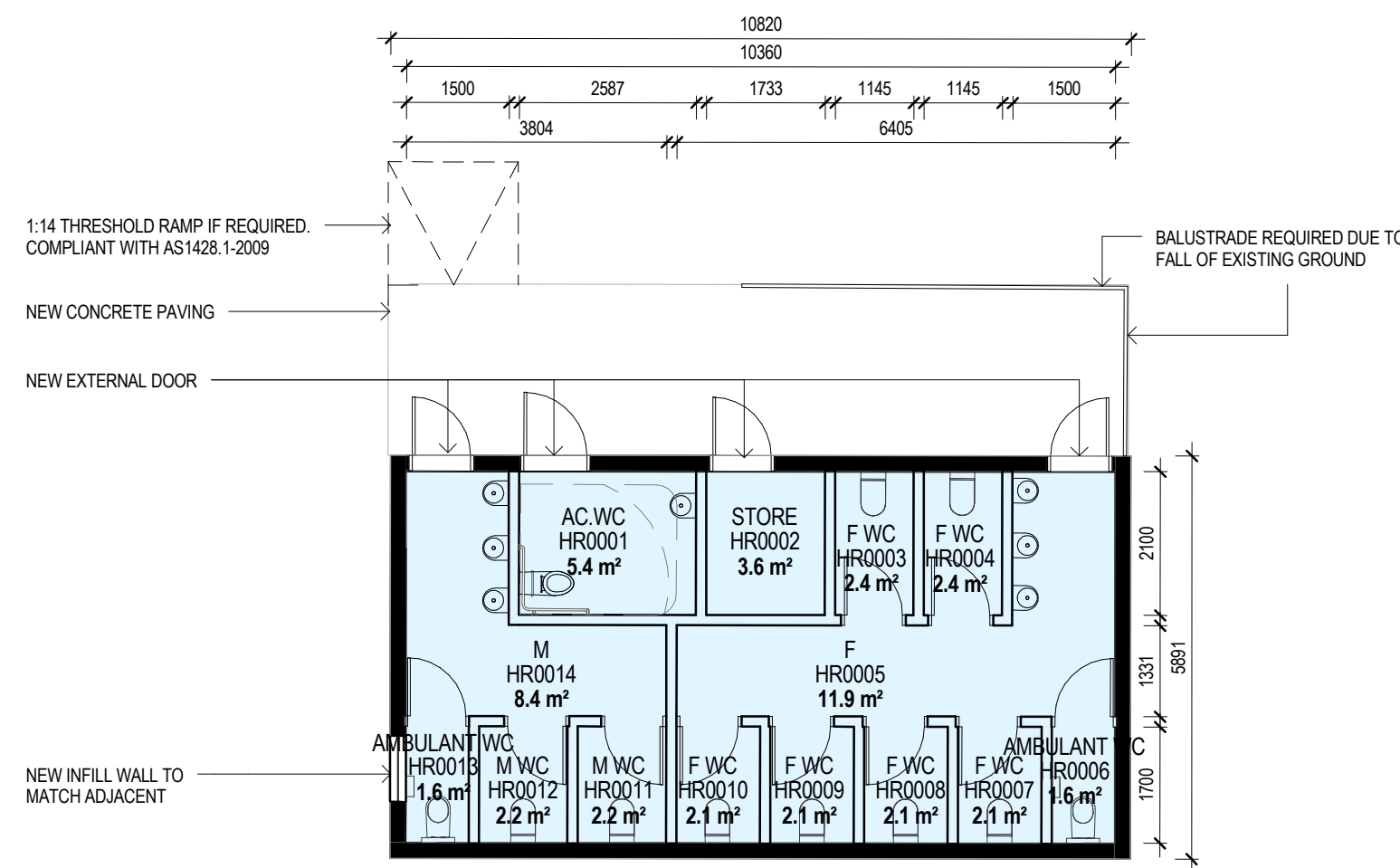



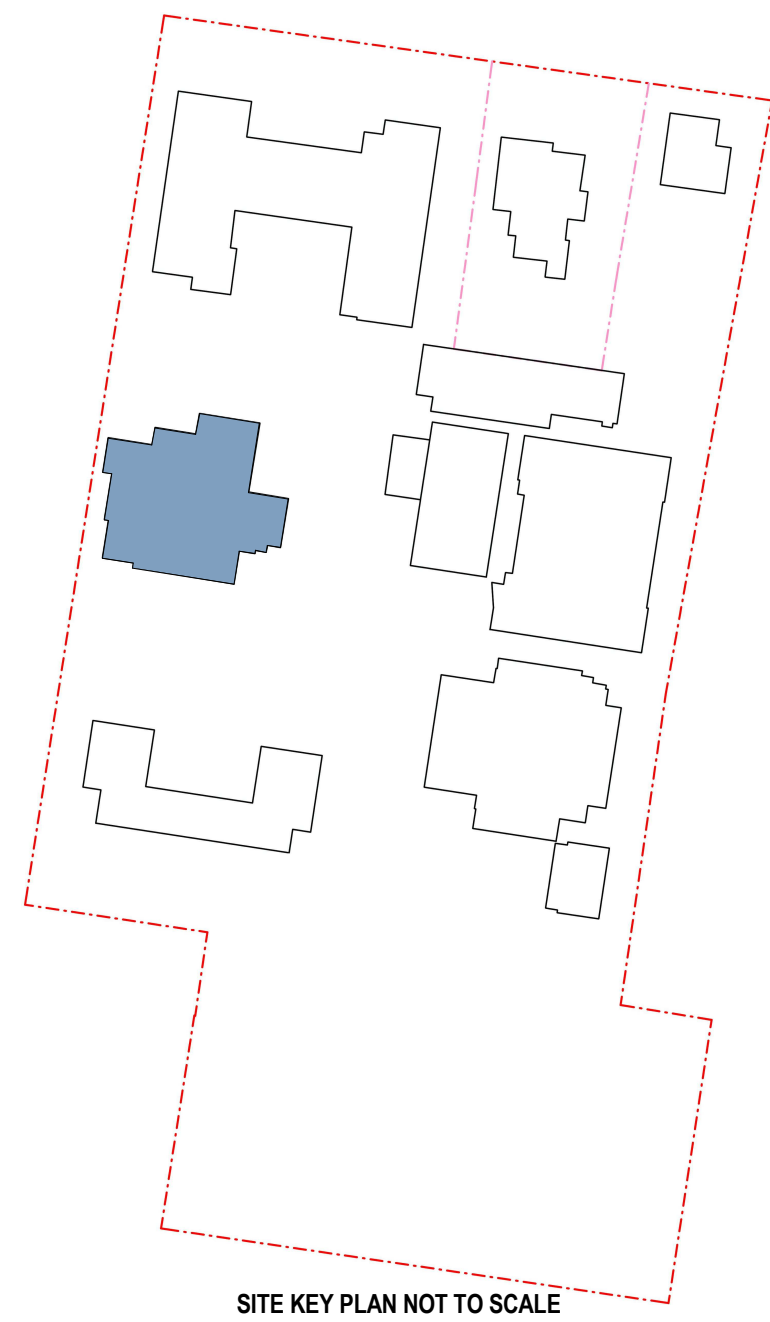
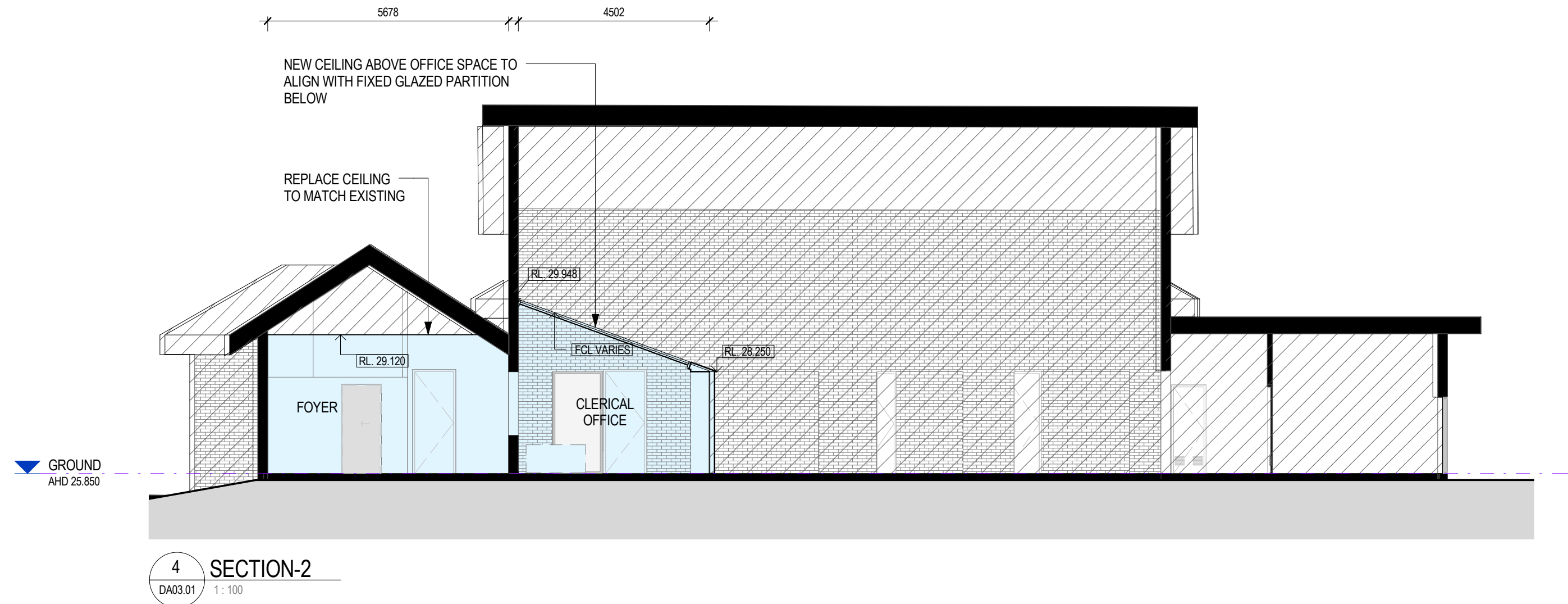
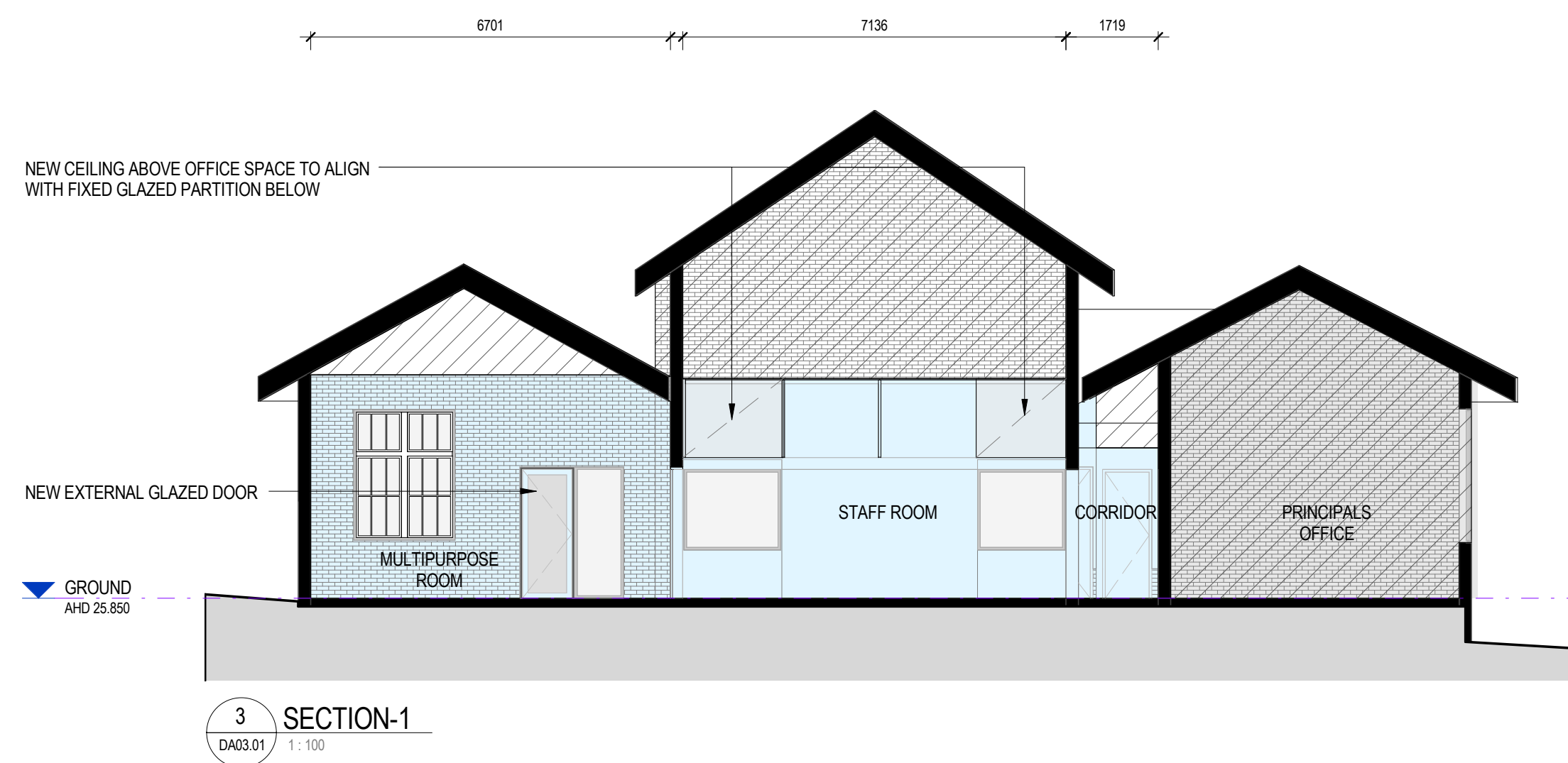
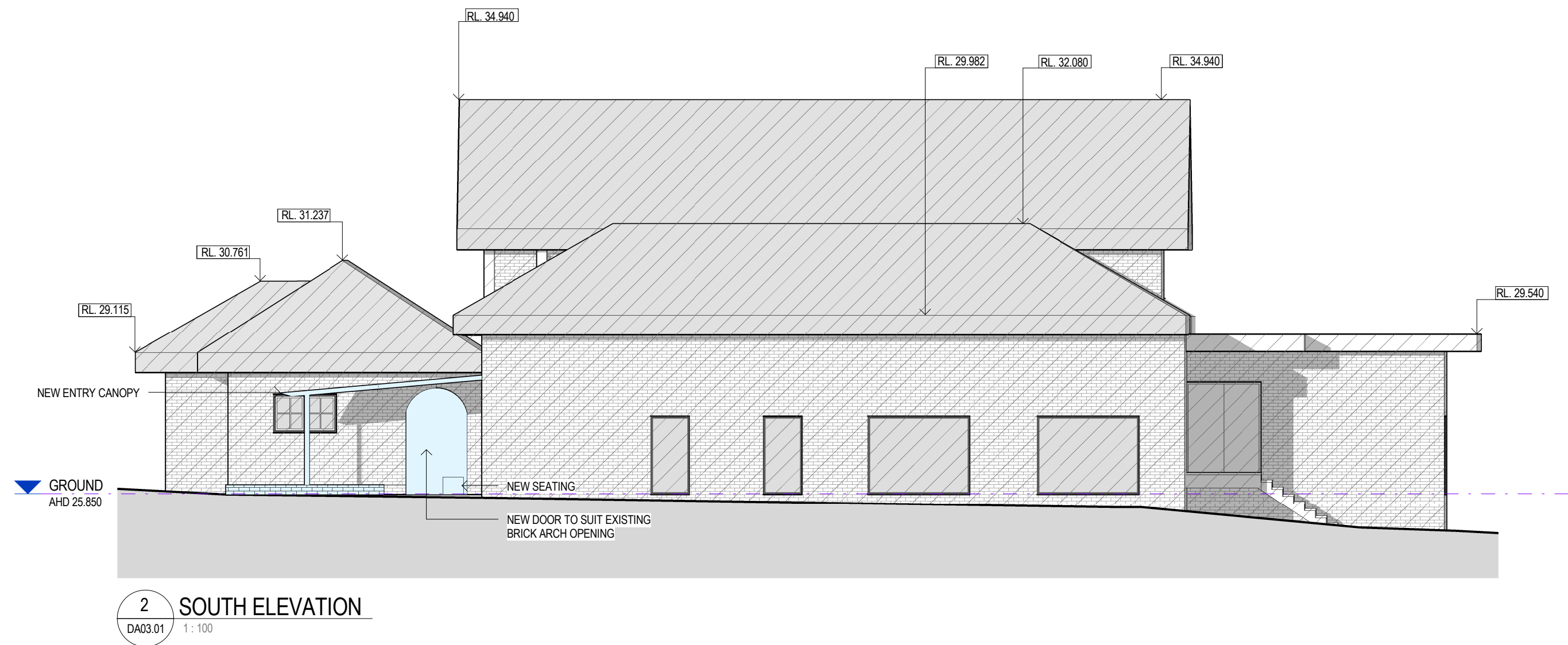
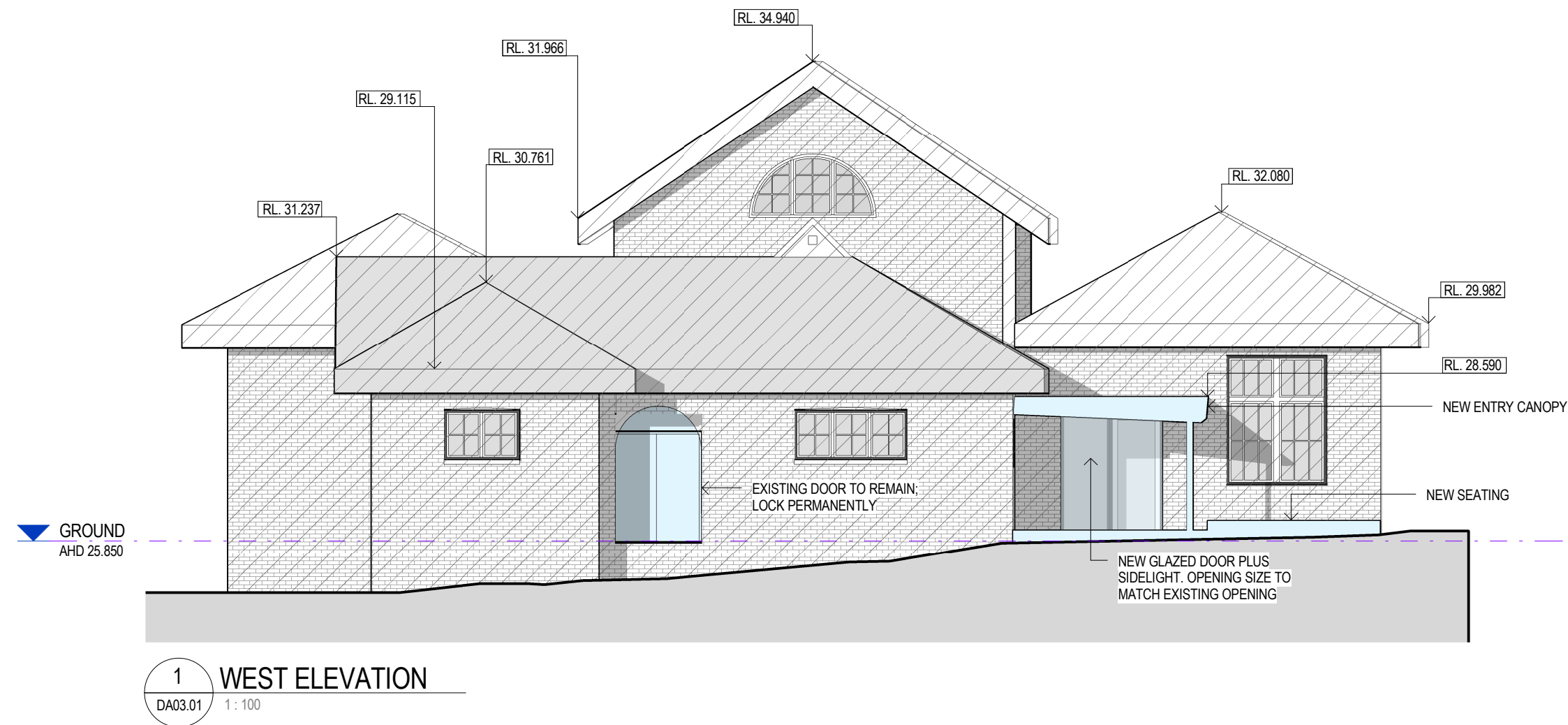

#### LEGEND

- BOUNDARY
- EXISTING
- PROPOSED REFURBISHMENT WORKS

3	REVISED FOR DEVELOPMENT APPLICATION	18.04.2018
2	DEVELOPMENT APPLICATION	07.11.2017
1	DRAFT DEVELOPMENT APPLICATION	24.10.2017
Rev	Description	Date

#### DEVELOPMENT APPLICATION

**hayball**

**Melbourne**  
4/135 Sturt Street Southbank, Victoria Australia 3006  
T +61 3 9699 3644  
www.hayball.com.au

**Sydney**  
7/1 26-32 Pirrama Road, Pyrmont NSW 2009  
T +61 2 9660 9329

**Brisbane**  
Level 12, 324 Queen Street, Brisbane Qld 4000  
T +61 7 3211 9821

**NSW Nominated Architects:**  
Tom Jordan 7521, Richard Leonard 7522, David Tordoff 8028  
ABN 84 006 394 261

Bidders/Contractors shall verify job dimensions before any job commences. Figured dimensions shall take precedence over scaled work. Work shall also conform to the specification, other drawings and job dimensions. All shop drawings shall be submitted to the Architect/Consultant and manufacturers shall not commence prior to the return of inspected shop drawings signed by the Architect/Consultant. © Copyright 2008 All rights reserved.

Client:



**Wollongong Public School**

BLOCK B, H

67A Church Street, Wollongong, NSW 2500

#### DRAWINGTITLE PROPOSED ELEVATIONS AND SECTIONS

DRAWN BY VC  
CHECKED RC  
DATE PRINTED 18/04/2018 9:44:06 AM  
SCALE 1:100@A1 1:200@A3

PROJECT NUMBER DWG NO REVISION

**2141.10 A10.DA06.01 3**



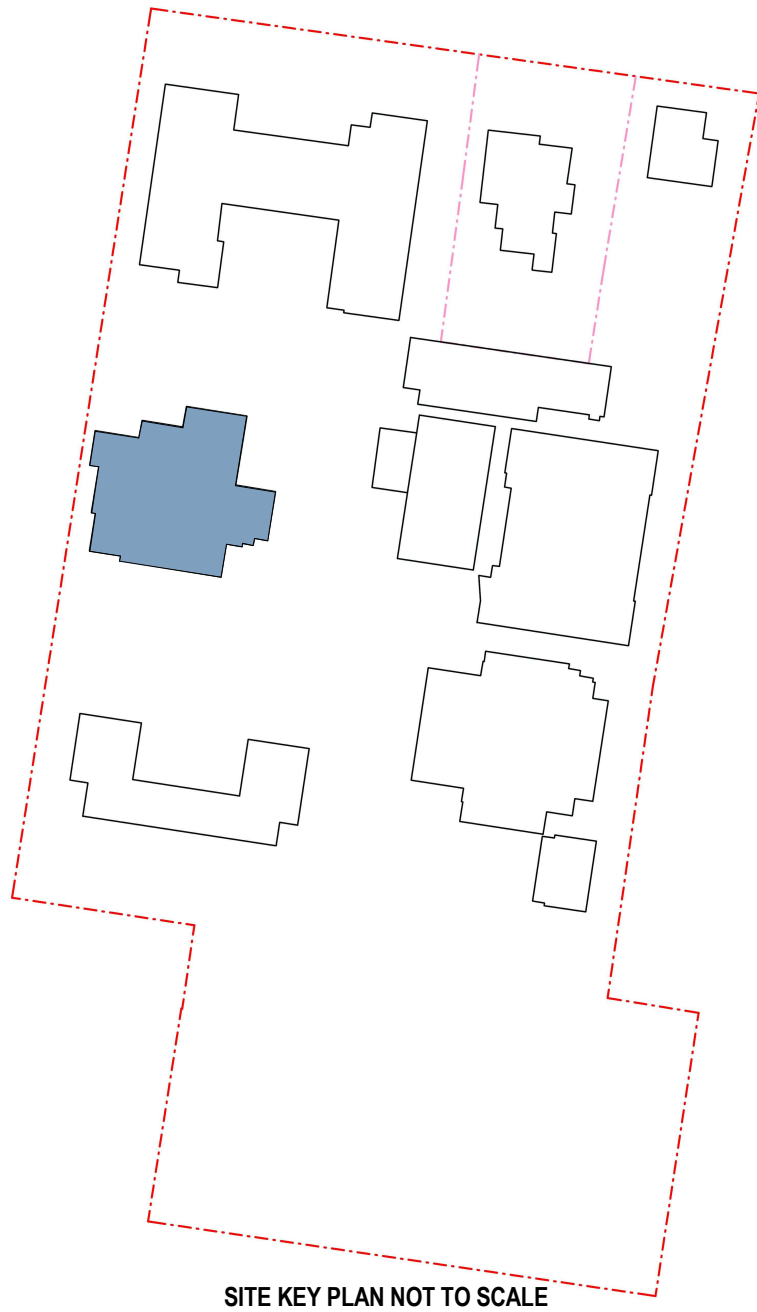
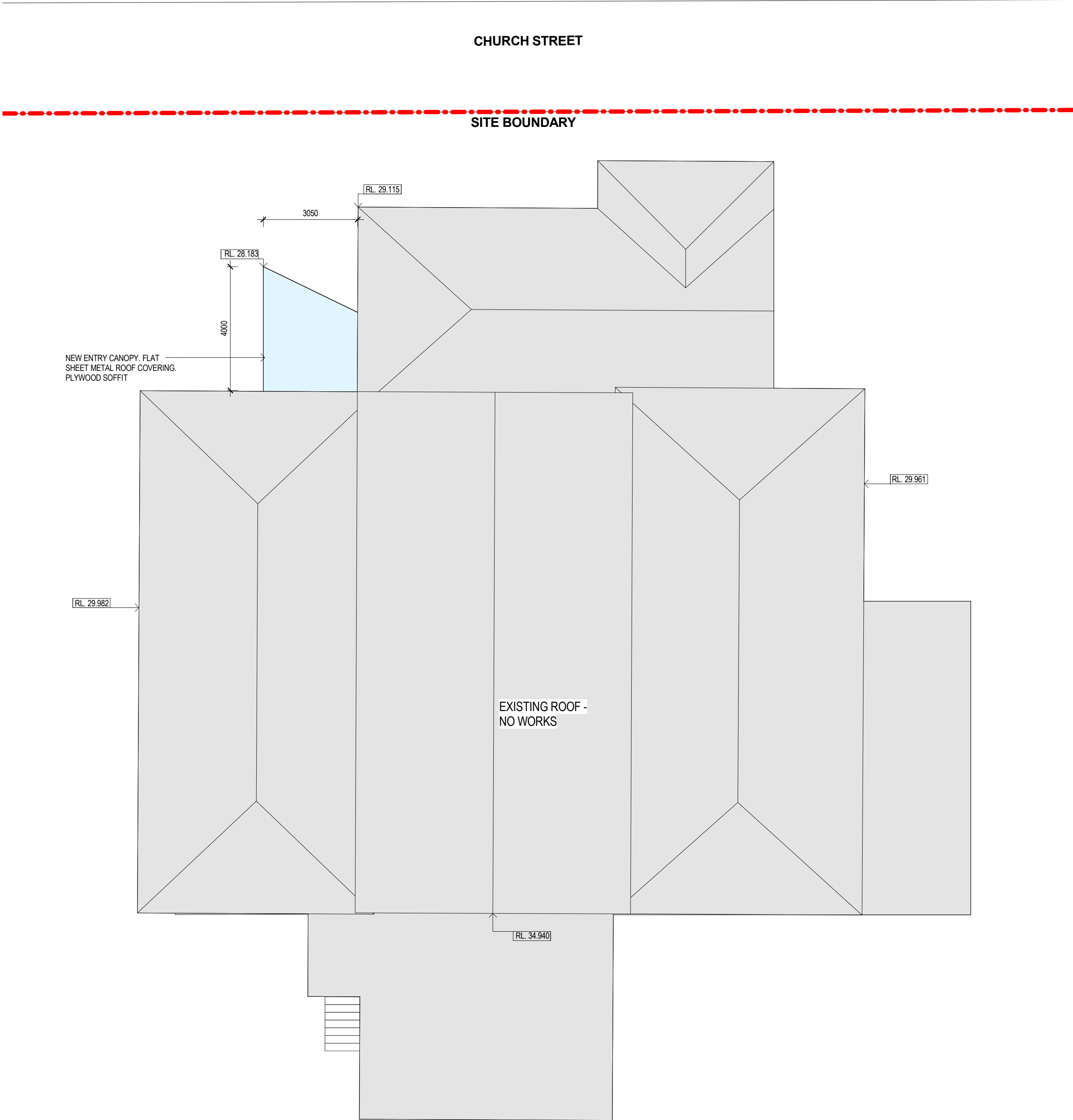

LEGEND

--- BOUNDARY

EXISTING AREA

PROPOSED REFURBISHMENT WORKS

2	DEVELOPMENT APPLICATION	07.11.2017
1	DRAFT DEVELOPMENT APPLICATION	24.10.2017
Rev	Description	Date

DEVELOPMENT APPLICATION

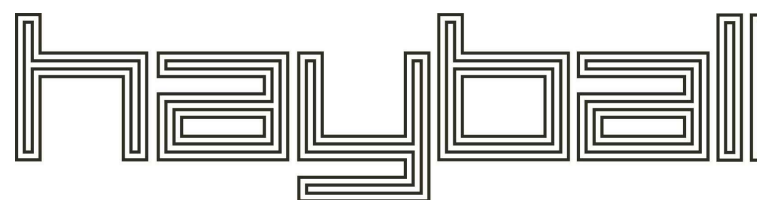

**Melbourne**  
4/135 Sturt Street Southbank, Victoria Australia 3006  
T 0+61 3 9699 3644  
www.hayball.com.au

**Sydney**  
7/1/26-32 Pirrama Road, Pyrmont NSW 2009  
T +61 2 9660 9329

**Brisbane**  
Level 12, 324 Queen Street, Brisbane Qld 4000  
T +61 7 3211 9821

**NSW Nominated Architects:**  
Tom Jordan 7521, Richard Leonard 7522, David Tordoff 8028  
ABN 84 006 394 261

Bidders/Contractors shall verify job dimensions before any job commences. Figured dimensions shall take precedence over scaled work. Work shall also conform to the specification, other drawings and job dimensions. All shop drawings shall be submitted to the Architect/Consultant and manufacturers shall not commence prior to the return of inspected shop drawings signed by the Architect/Consultant. © Copyright 2008 All rights reserved.

Client:

 **Education**

**Wollongong Public School**

BLOCK B, H

67A Church Street, Wollongong, NSW 2500

DRAWING TITLE  
**PROPOSED ROOF PLAN**

DRAWN BY	VC	
CHECKED	RC	
DATE PRINTED	7/11/2017 5:45:57 PM	
SCALE	1: 100@A1 1:200@A3	

PROJECT NUMBER	DWG NO	REVISION
<b>2141.10</b>	<b>A10.DA03.10</b>	<b>2</b>



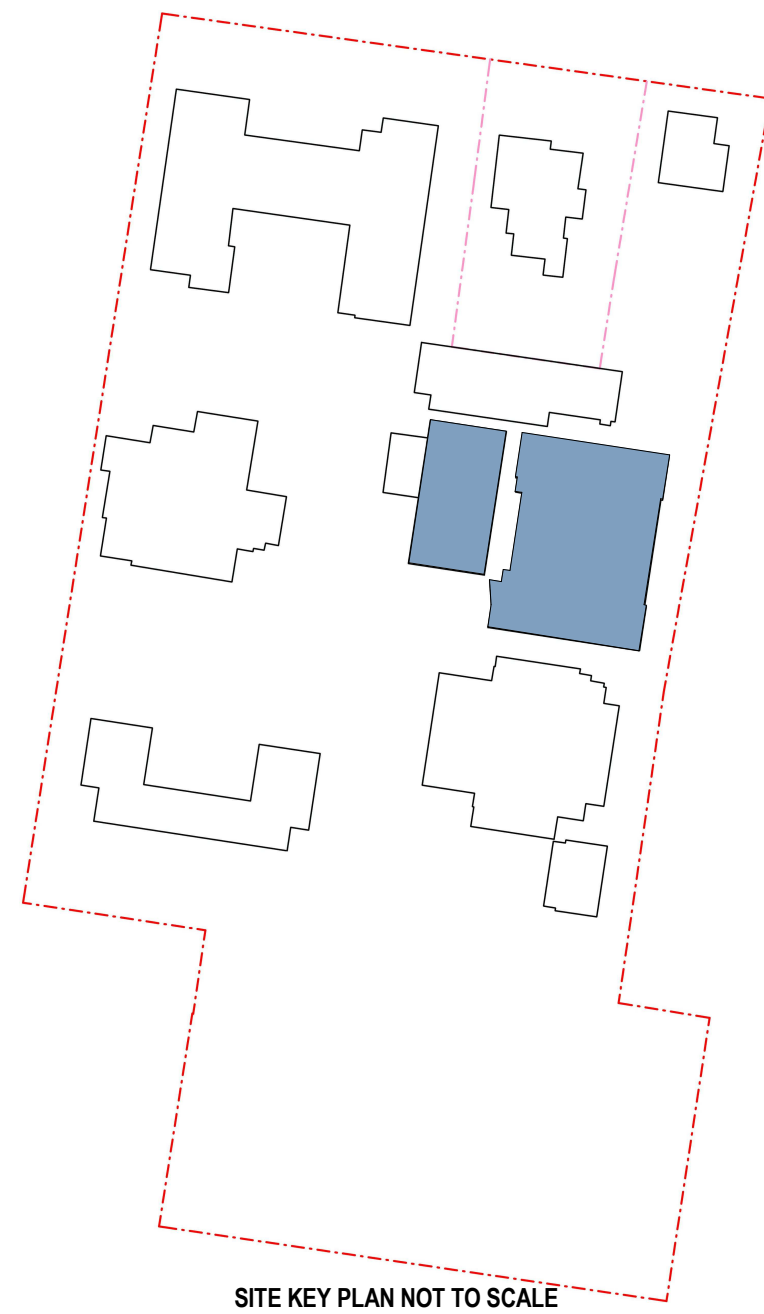
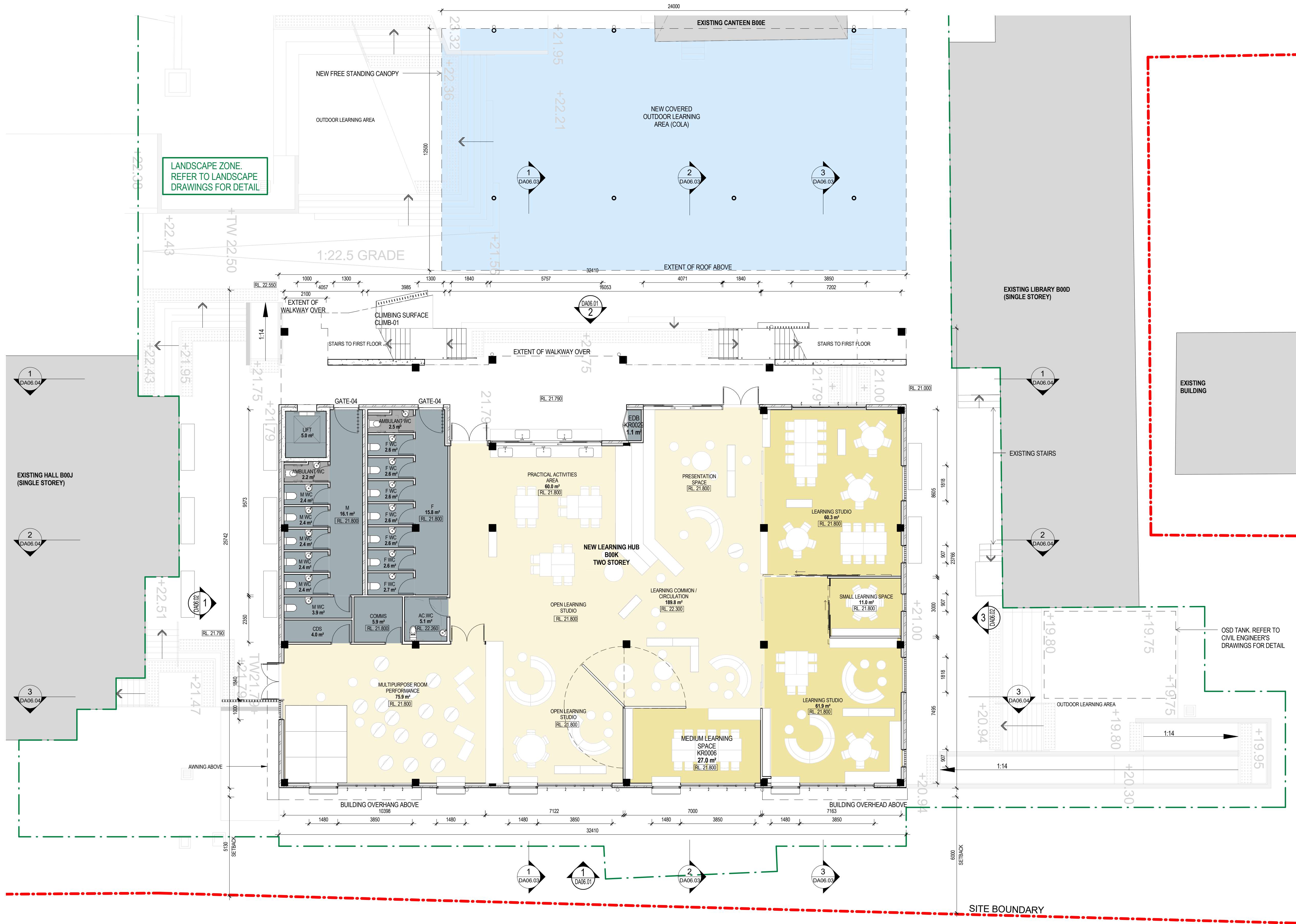

LEGEND			
---			
BOUNDARY			
---			
EXISTING AREA			

3	REVISED FOR DEVELOPMENT APPLICATION	09.11.2017
2	DEVELOPMENT APPLICATION	07.11.2017
1	DRAFT DEVELOPMENT APPLICATION	24.10.2017
Rev	Description	Date

## DEVELOPMENT APPLICATION

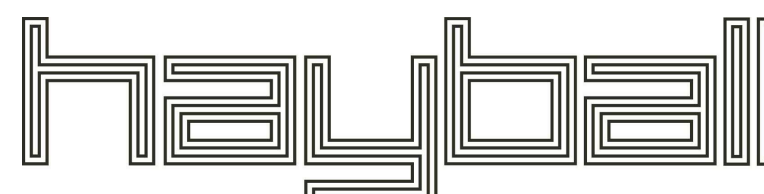

**Melbourne**  
4/135 Sturt Street Southbank, Victoria Australia 3006  
T +61 3 9699 3644  
www.hayball.com.au

**Sydney**  
71/ 26-32 Pirrama Road, Pyrmont NSW 2009  
T +61 2 9660 9329

**Brisbane**  
Level 12, 324 Queen Street, Brisbane Qld 4000  
T +61 7 3211 9821

**NSW Nominated Architects:**  
Tom Jordan 7521, Richard Leonard 7522, David Tordoff 8028  
ABN 84 006 394 261

Builder/Contractors shall verify job dimensions before any job commences. Figured dimensions shall take precedence over scaled work. Work shall also conform to the specification, other drawings and job dimensions. All shop drawings shall be submitted to the Architect/Consultant and modifications shall not commence prior to the return of inspected shop drawings signed by the Architect/Consultant. © Copyright 2008 All rights reserved.

Client:



**Wollongong Public School**  
BLOCK B00K  
67A Church Street, Wollongong, NSW 2500

DRAWING TITLE  
**FLOOR PLAN - GROUND FLOOR**

DRAWN BY	VC
CHECKED	RC
DATE PRINTED	9/11/2017 5:54:09 PM
SCALE	1 : 100@A1 1:200@A3

PROJECT NUMBER	DWG NO	REVISION
----------------	--------	----------

**2141.10 B10.DA03.01 3**



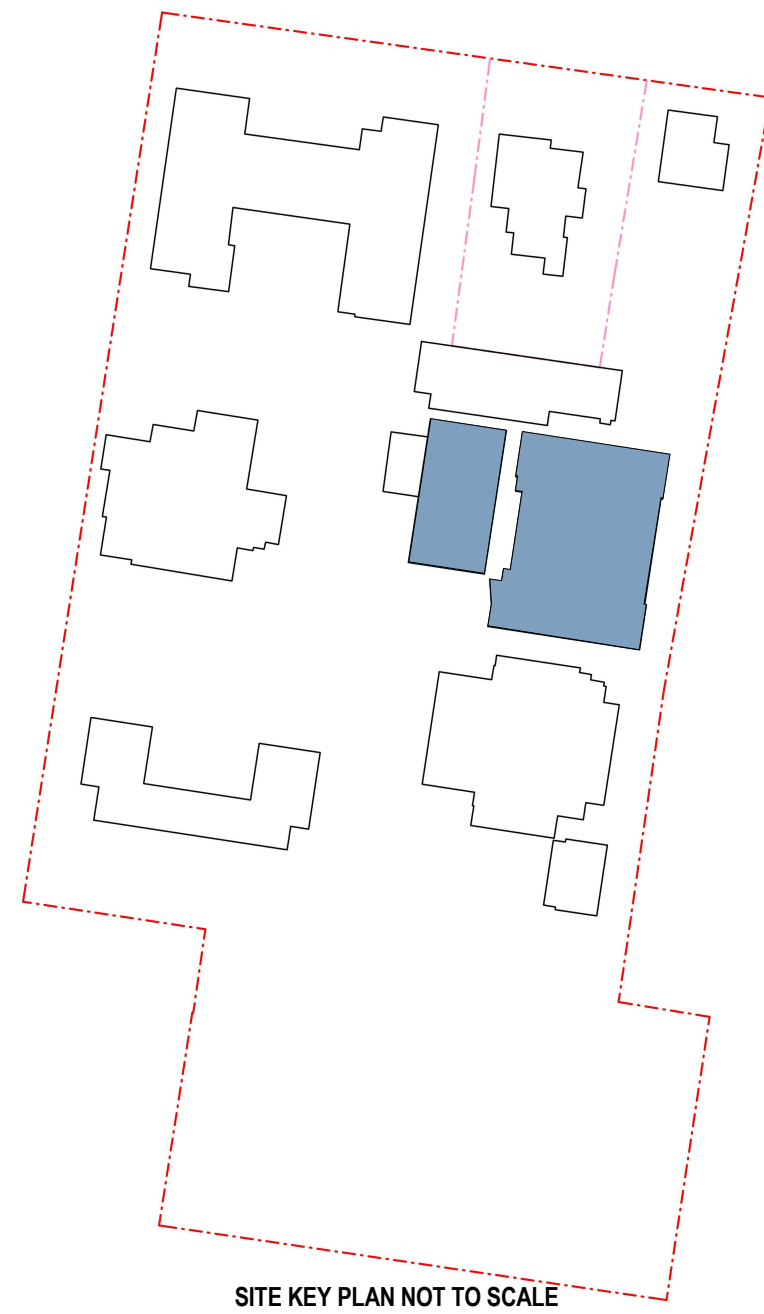
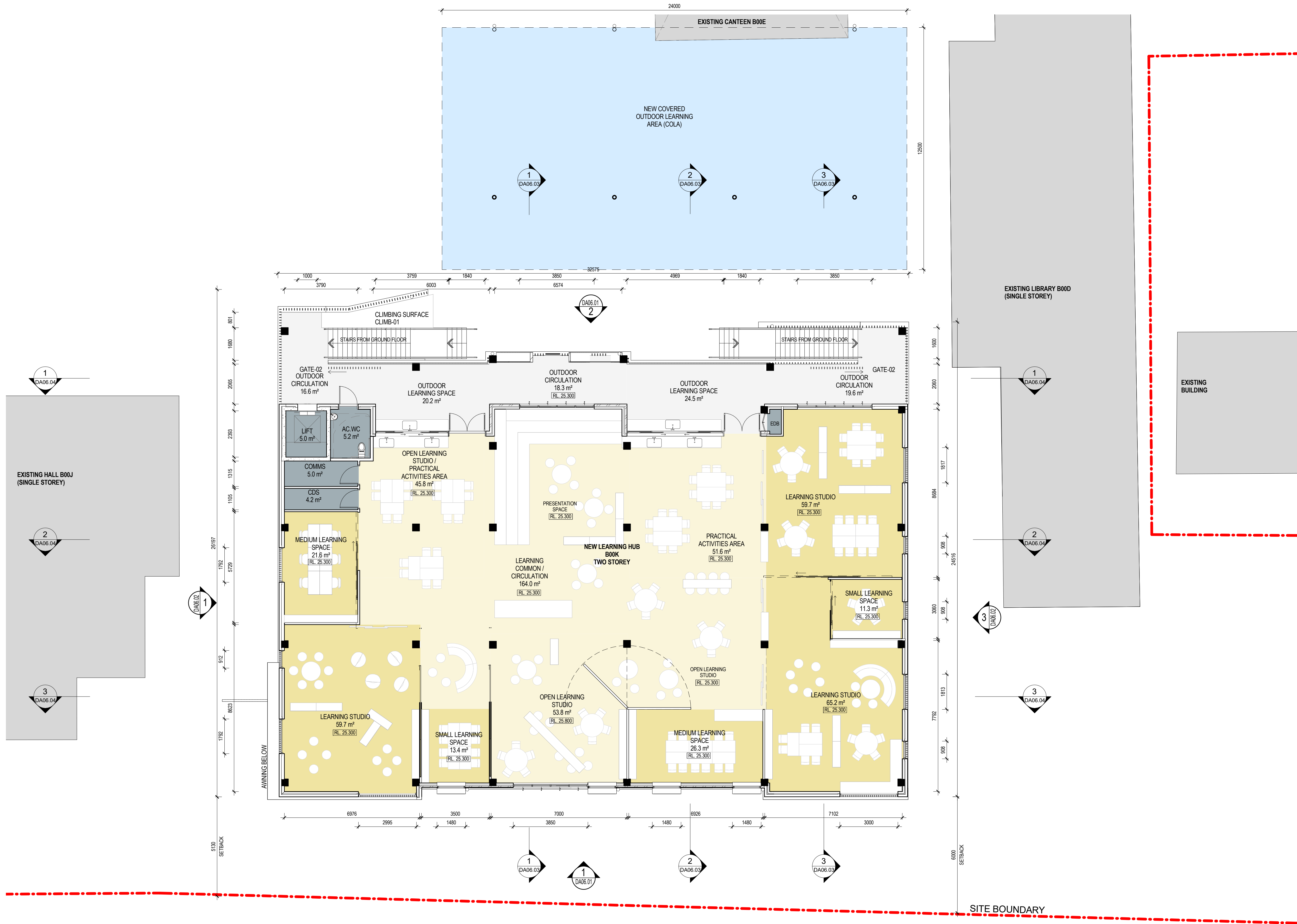

#### LEGEND

- BOUNDARY
- EXISTING AREA

3	REVISED FOR DEVELOPMENT APPLICATION	09.11.2017
2	DEVELOPMENT APPLICATION	07.11.2017
1	DRAFT DEVELOPMENT APPLICATION	24.10.2017
Rev	Description	Date

#### DEVELOPMENT APPLICATION

hayball

**Melbourne**  
4/135 Sturt Street Southbank, Victoria Australia 3006  
T 0+61 3 9699 3644  
www.hayball.com.au

**Sydney**  
7/1/26-32 Pirrama Road, Pyrmont NSW 2009  
T +61 2 9660 9329

**Brisbane**  
Level 12, 324 Queen Street, Brisbane Qld 4000  
T +61 7 3211 9821

**NSW Nominated Architects:**  
Tom Jordan 7521, Richard Leonard 7522, David Tordoff 8028  
ABN 84 006 394 261

Builders/Contractors shall verify job dimensions before any job commences. Figured dimensions shall take precedence over scaled work. Work shall also conform to the specification, other drawings and job dimensions. All shop drawings shall be submitted to the Architect/Consultant and modifications shall not commence prior to the return of inspected shop drawings signed by the Architect/Consultant. © Copyright 2008 All rights reserved.

Client:



**Wollongong Public School**  
BLOCK B00K  
67A Church Street, Wollongong, NSW 2500

DRAWING TITLE  
**FLOOR PLAN - FIRST FLOOR**

DRAWN BY VC  
CHECKED RC  
DATE PRINTED 9/11/2017 5:54:14 PM  
SCALE 1: 100@A1 1:200@A3



PROJECT NUMBER DWG NO REVISION

**2141.10 B10.DA03.02 3**



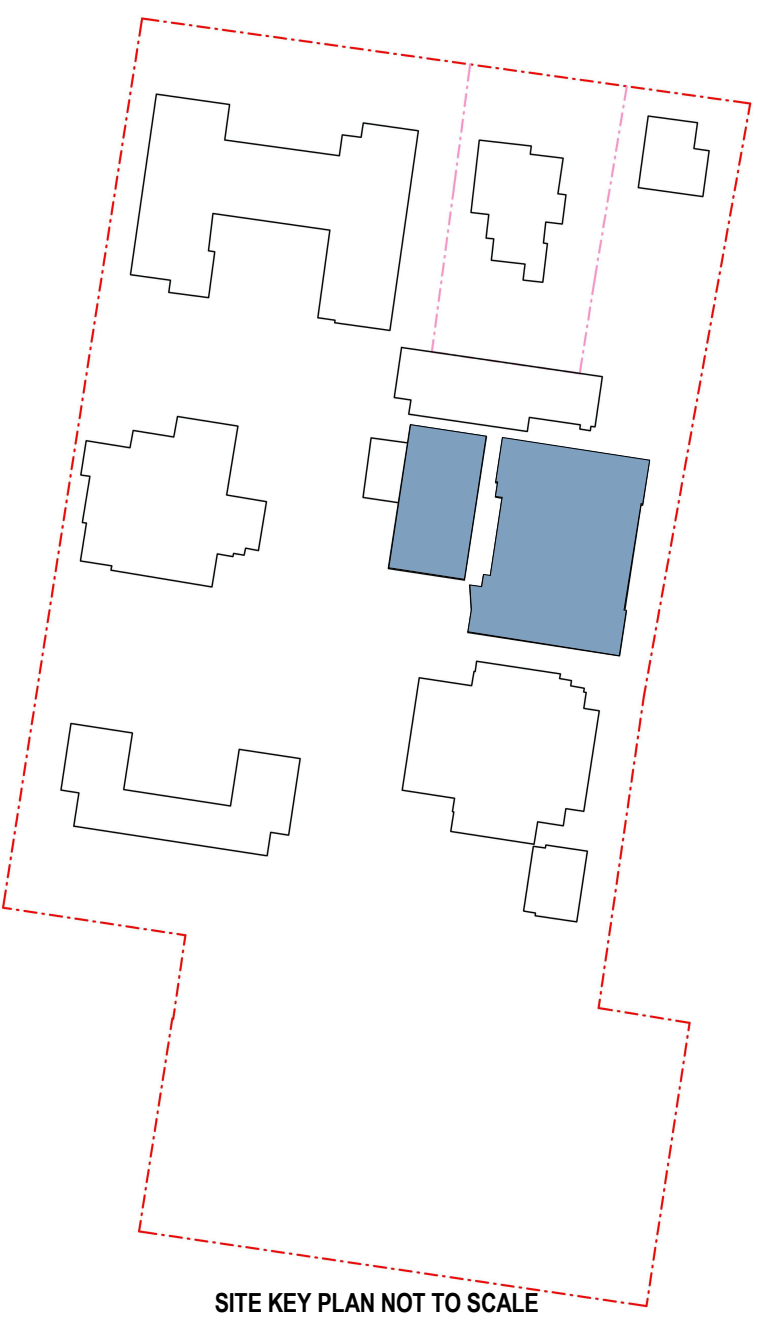
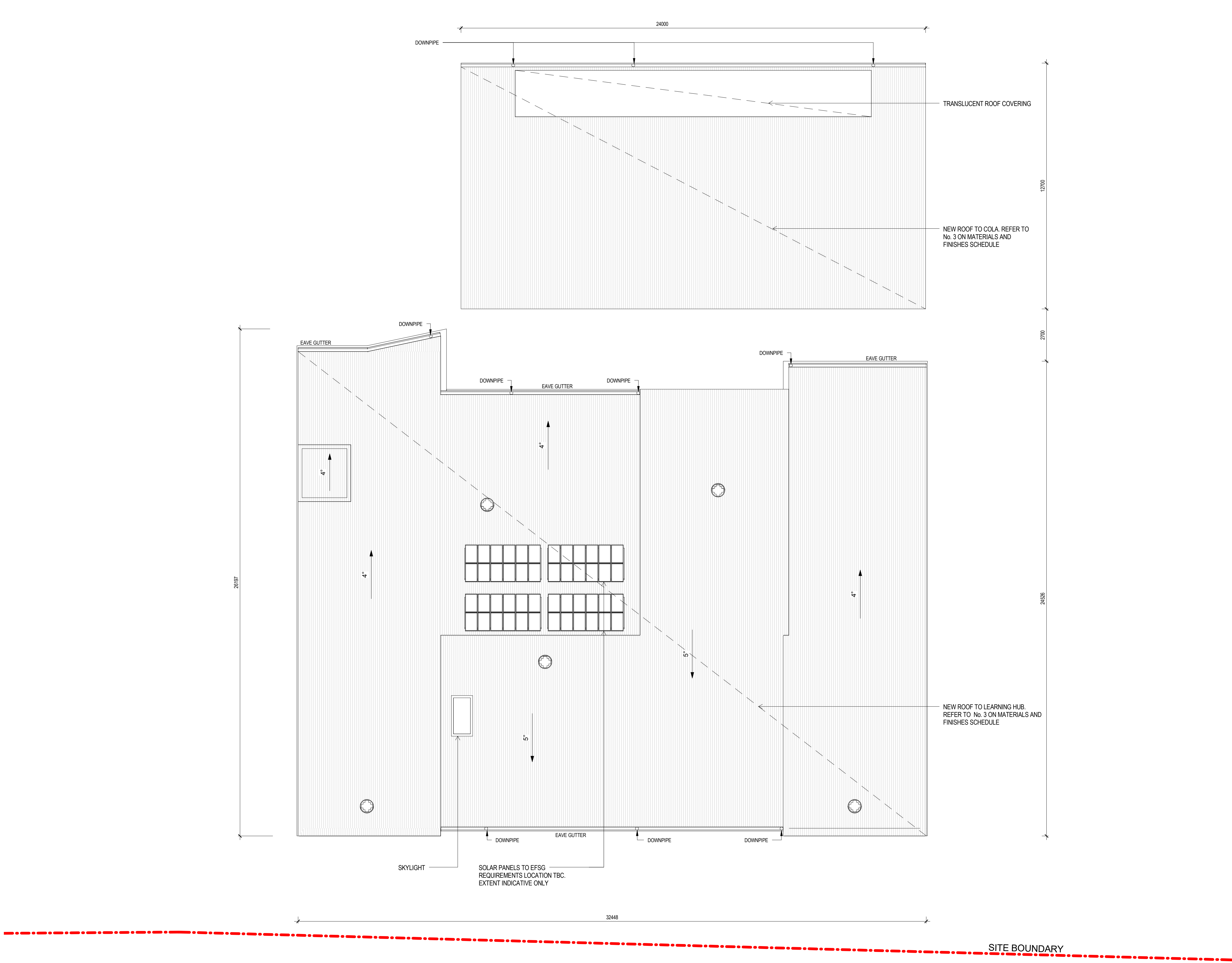

2	DEVELOPMENT APPLICATION	07.11.2017
1	DRAFT DEVELOPMENT APPLICATION	24.10.2017
Rev	Description	Date

## DEVELOPMENT APPLICATION

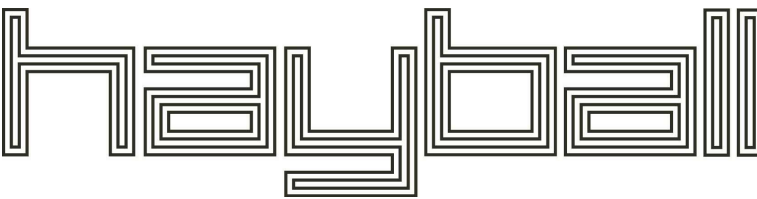

**Melbourne**  
4/135 Sturt Street Southbank, Victoria Australia 3006  
T 0+61 3 9699 3644  
www.hayball.com.au

**Sydney**  
7/1/ 26-32 Pirrama Road, Pyrmont NSW 2009  
T +61 2 9660 9329

**Brisbane**  
Level 12, 324 Queen Street, Brisbane Qld 4000  
T +61 7 3211 9821

**NSW Nominated Architects:**  
Tom Jordan 7521, Richard Leonard 7522, David Tordoff 8028  
ABN 84 006 394 261

Builders/Contractors shall verify job dimensions before any job commences. Figured dimensions shall take precedence over scaled work. Work shall also conform to the specification, other drawings and job dimensions. All shop drawings shall be submitted to the Architect/Consultant and manufacturers shall not commence prior to the return of inspected shop drawings signed by the Architect/Consultant. © Copyright 2009 All rights reserved

Client:



**Wollongong Public School**  
BLOCK B00K  
67A Church Street, Wollongong, NSW 2500

DRAWING TITLE  
**ROOF PLAN**

DRAWN BY VC  
CHECKED RC  
DATE PRINTED 7/11/2017 4:07:15 PM  
SCALE 1: 100@A1 1:200@A3

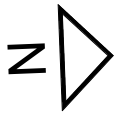

PROJECT NUMBER DWG NO REVISION  
**2141.10 B10.DA03.03 2**



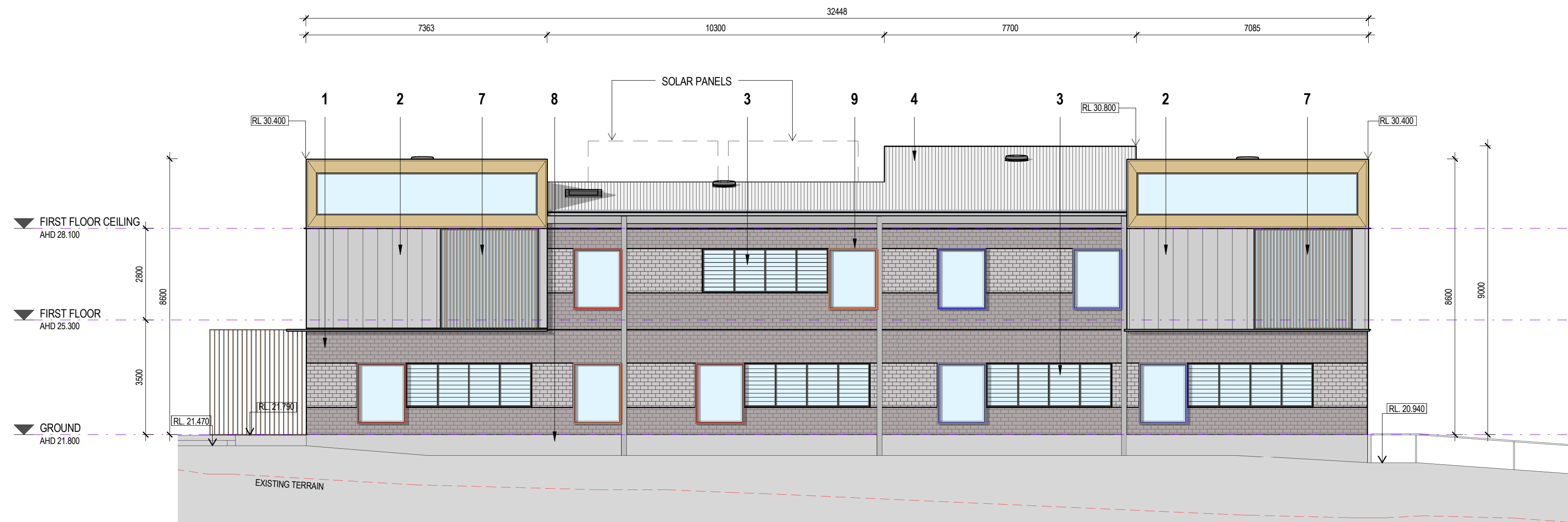

1 EAST ELEVATION  
DA03.01 1:100

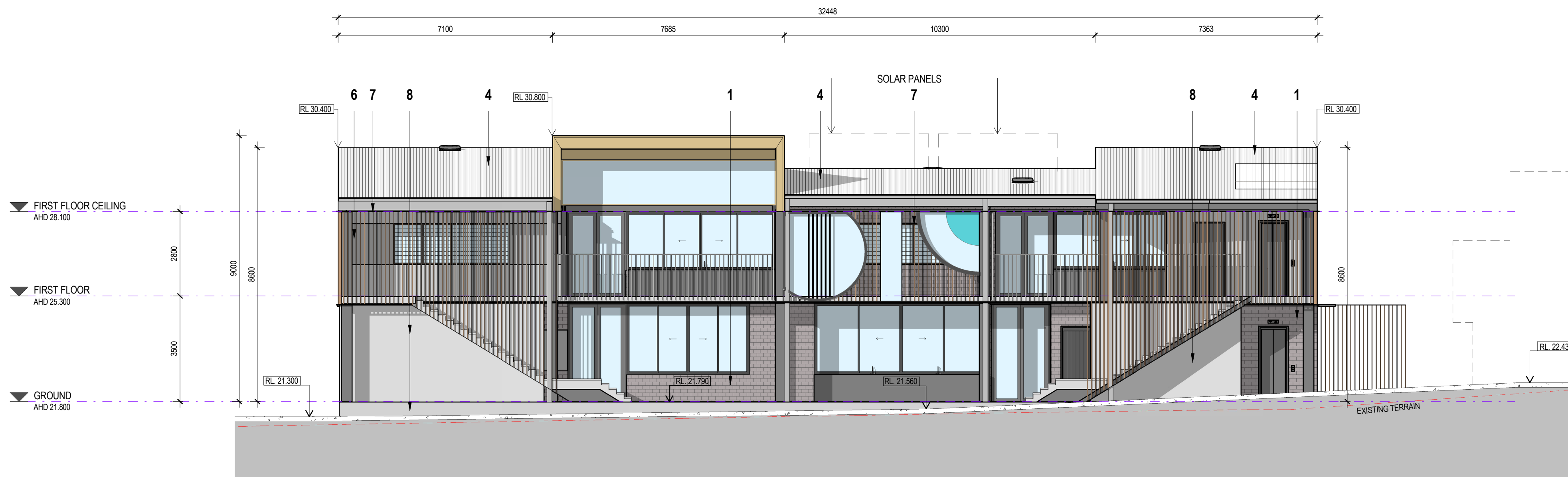

2 WEST ELEVATION  
DA03.01 1:100

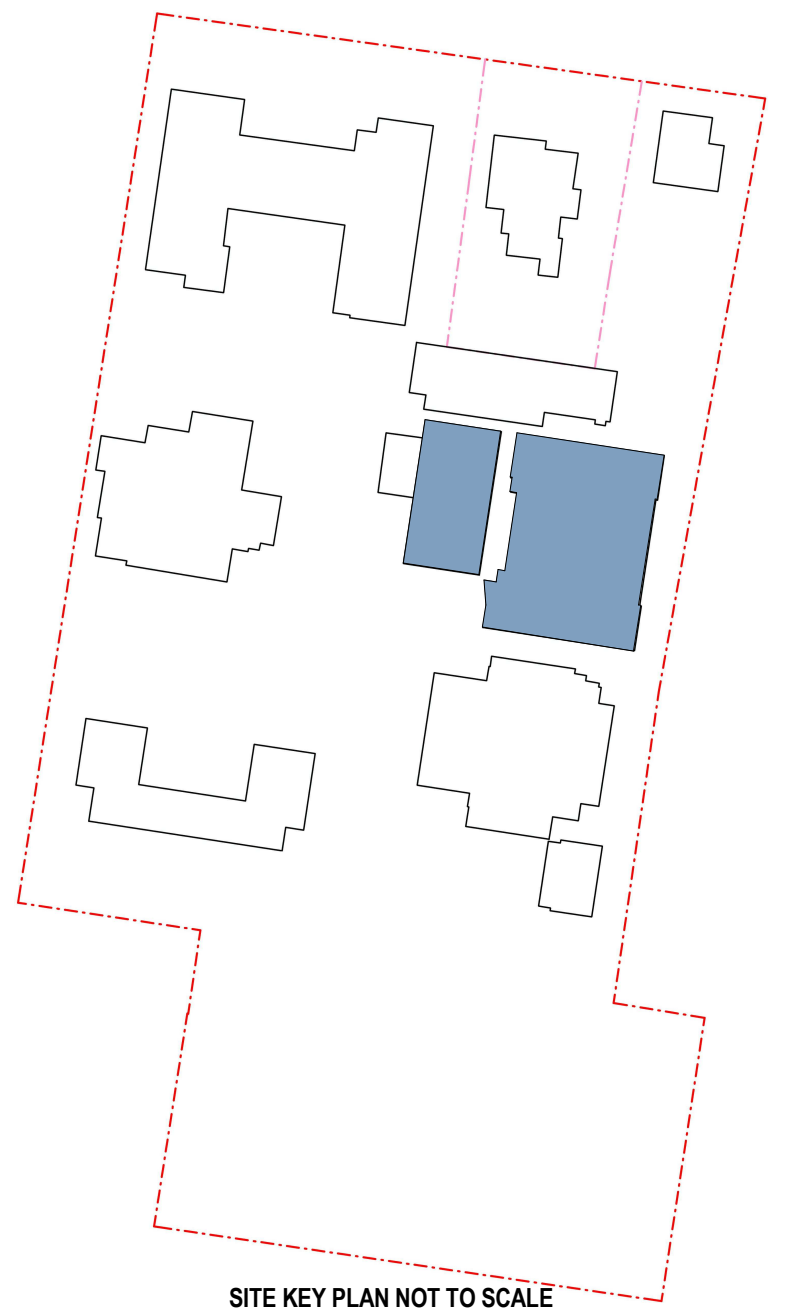

#### REFER TO DA20.00 'MATERIALS AND FINISHES'

1. PGH MOWBRAY BLUE SPLITS BRICK
2. CSR CEMINTEL - BARESTONE FINISH
3. ALTAIR GLASS LOUVRE SYSTEM
4. BLUESCOPE ZINCALUME ROOFING - SPANDEK PROFILE
5. EXTERNAL PLYWOOD SOFFIT
6. WRITABLE SURFACE
7. ALUMINIUM LOUVRES - ELLIPSOID BLADES
8. CONCRETE-IN SITU
9. POWDERCOATED FOLDED ALUMINIUM

2	DEVELOPMENT APPLICATION	07.11.2017
1	DRAFT DEVELOPMENT APPLICATION	24.10.2017
Rev	Description	Date

#### DEVELOPMENT APPLICATION

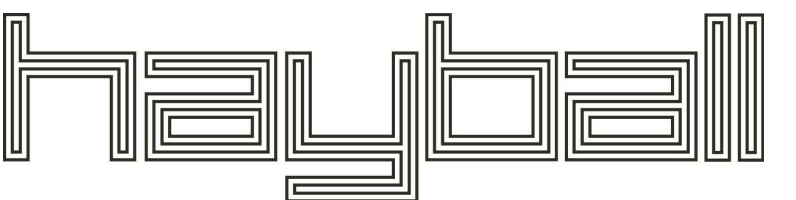

**Melbourne**  
4/135 Sturt Street Southbank, Victoria Australia 3006  
T 0+61 3 9699 3644  
www.hayball.com.au

**Sydney**  
71/ 26-32 Pirrama Road, Pyrmont NSW 2009  
T +61 2 9660 9329

**Brisbane**  
Level 12, 324 Queen Street, Brisbane Qld 4000  
T +61 7 3211 9821

**NSW Nominated Architects:**  
Tom Jordan 7521, Richard Leonard 7522, David Tordoff 8028  
ABN 84 006 394 261

Builders/Contractors shall verify job dimensions before any job commences. Planned dimensions shall take precedence over scaled work. Work shall also conform to the specification, other drawings and job dimensions. All shop drawings shall be submitted to the Architect/Consultant and manufacturers shall not commence prior to the return of inspected shop drawings signed by the Architect/Consultant. © Copyright 2008 All rights reserved

Client:



**Wollongong Public School**  
BLOCK B00K  
67A Church Street, Wollongong, NSW 2500

#### DRAWING TITLE ELEVATIONS

DRAWN BY	VC
CHECKED	RC
DATE PRINTED	7/11/2017 5:53:25 PM
SCALE	1 : 100@A1 1:200@A3

PROJECT NUMBER	DWG NO	REVISION
2141.10	B10.DA06.01	2



SITE BOUNDARY

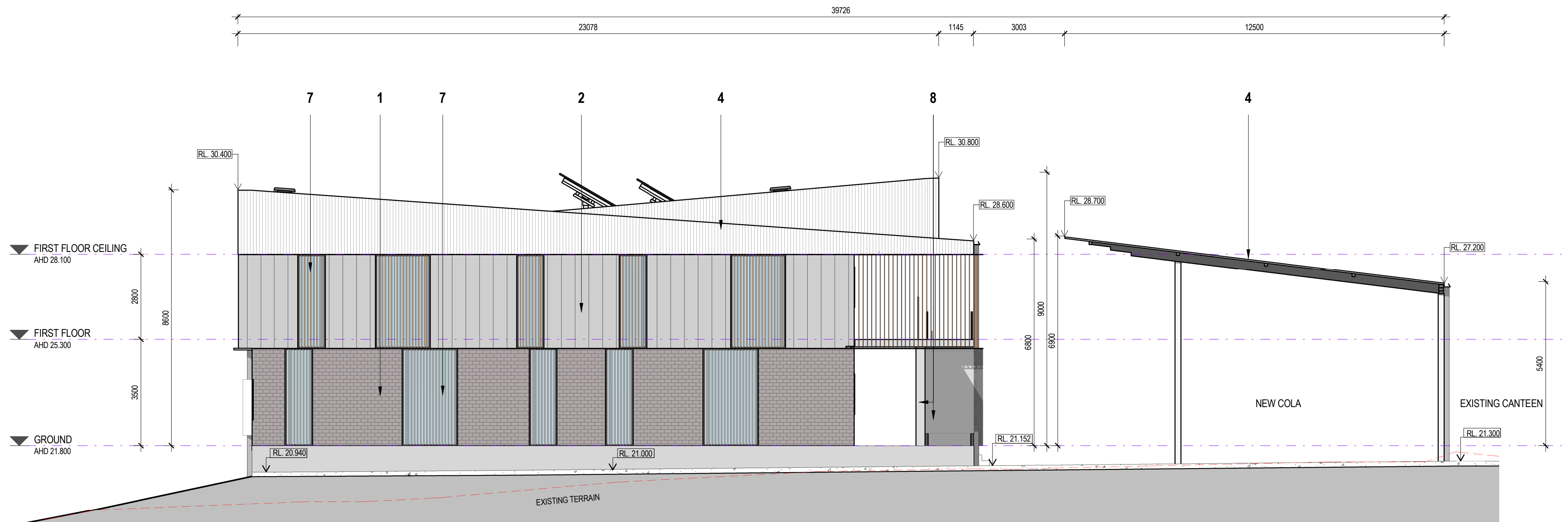

3 NORTH ELEVATION  
DA03.01 1:100

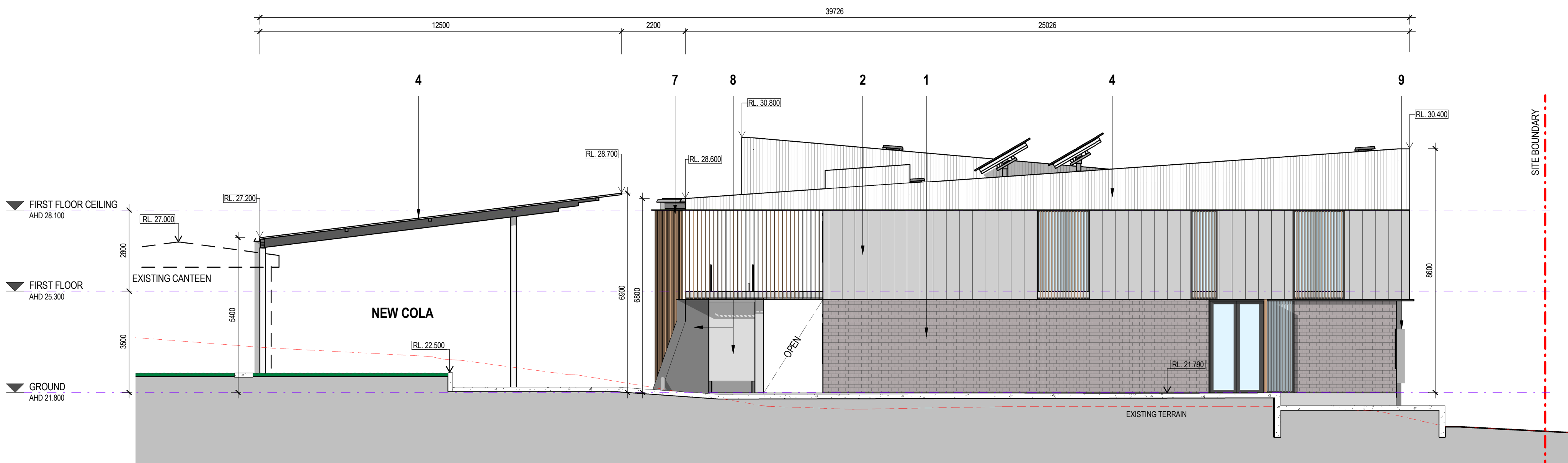

1 SOUTH ELEVATION  
DA03.01 1:100

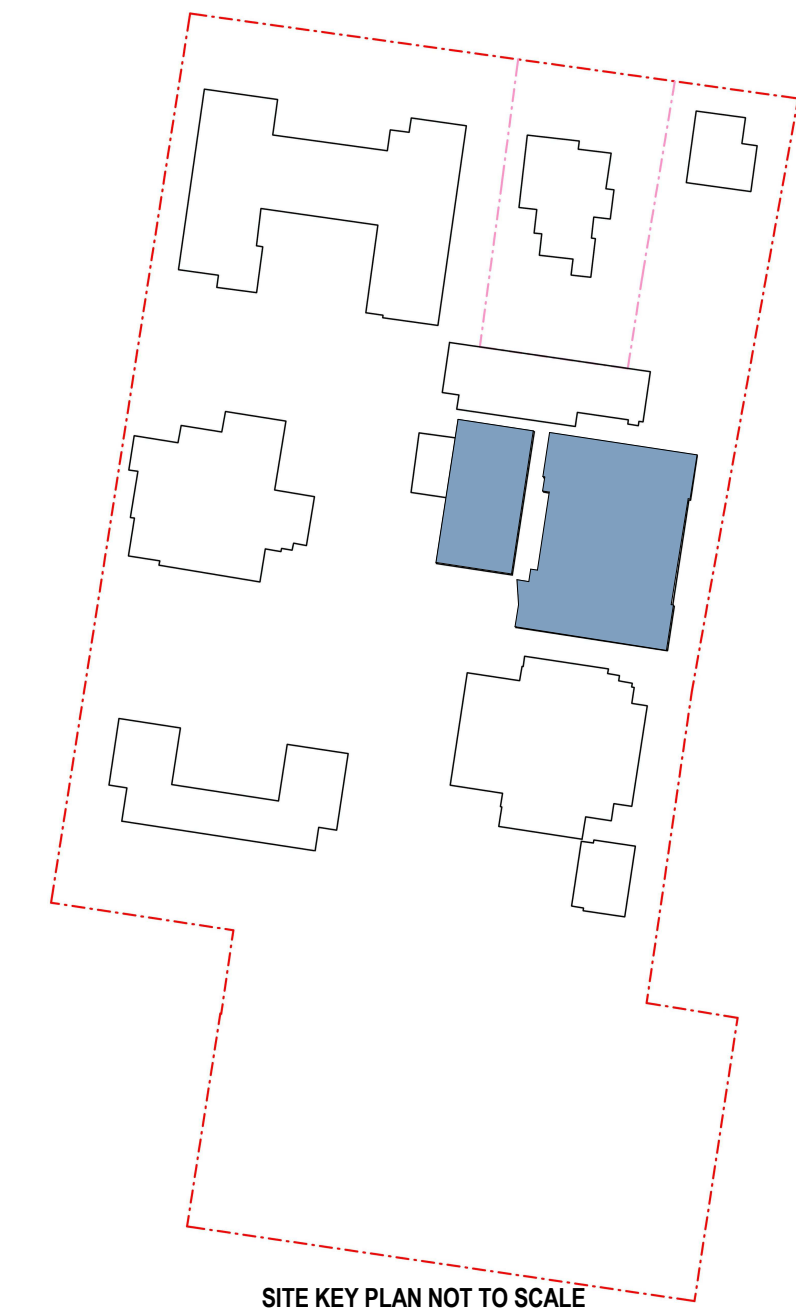

REFER TO DA20.00 'MATERIALS AND FINISHES'

1. PGH MOWBRAY BLUE SPLITS BRICK
2. CSR CEMINTEL - BARESTONE FINISH
3. ALTAIR GLASS LOUVRE SYSTEM
4. BLUESCOPE ZINCALUME ROOFING - SPANDEK PROFILE
5. EXTERNAL PLYWOOD SOFFIT
6. WRITABLE SURFACE
7. ALUMINIUM LOUVRES - ELLIPSOID BLADES
8. CONCRETE-IN SITU
9. POWDERCOATED FOLDED ALUMINIUM

3	REVISED FOR DEVELOPMENT APPLICATION	09.11.2017
2	DEVELOPMENT APPLICATION	07.11.2017
1	DRAFT DEVELOPMENT APPLICATION	24.10.2017
Rev	Description	Date

## DEVELOPMENT APPLICATION

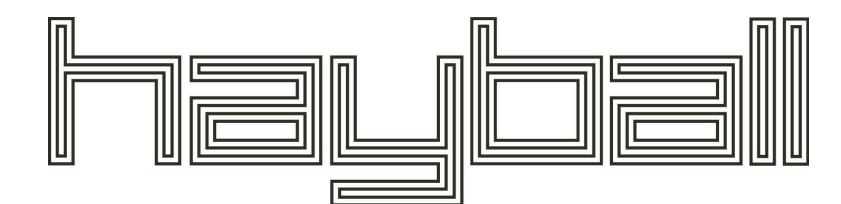

**Melbourne**  
4/135 Sturt Street Southbank, Victoria Australia 3006  
T 0+61 3 9699 3644  
www.hayball.com.au

**Sydney**  
71/ 26-32 Pirrama Road, Pyrmont NSW 2009  
T +61 2 9660 9329

**Brisbane**  
Level 12, 324 Queen Street, Brisbane Qld 4000  
T +61 7 3211 9821

**NSW Nominated Architects:**  
Tom Jordan 7521, Richard Leonard 7522, David Tordoff 8028  
ABN 84 006 394 261

Buildings/Contractors shall verify job dimensions before any job commences. Pinned dimensions shall take precedence over scaled work. Work shall also conform to the specification, other drawings and job dimensions. All shop drawings shall be submitted to the Architect/Consultant and manufacturers shall not commence prior to the return of inspected shop drawings signed by the Architect/Consultant. © Copyright 2008 All rights reserved

Client:



**Wollongong Public School**

BLOCK B00K

67A Church Street, Wollongong, NSW 2500

## DRAWING TITLE ELEVATIONS-2

DRAWN BY	VC
CHECKED	RC
DATE PRINTED	9/11/2017 5:54:24 PM
SCALE	1 : 100@A1 1:200@A3

PROJECT NUMBER	DWG NO	REVISION
----------------	--------	----------

**2141.10 B10.DA06.02 3**



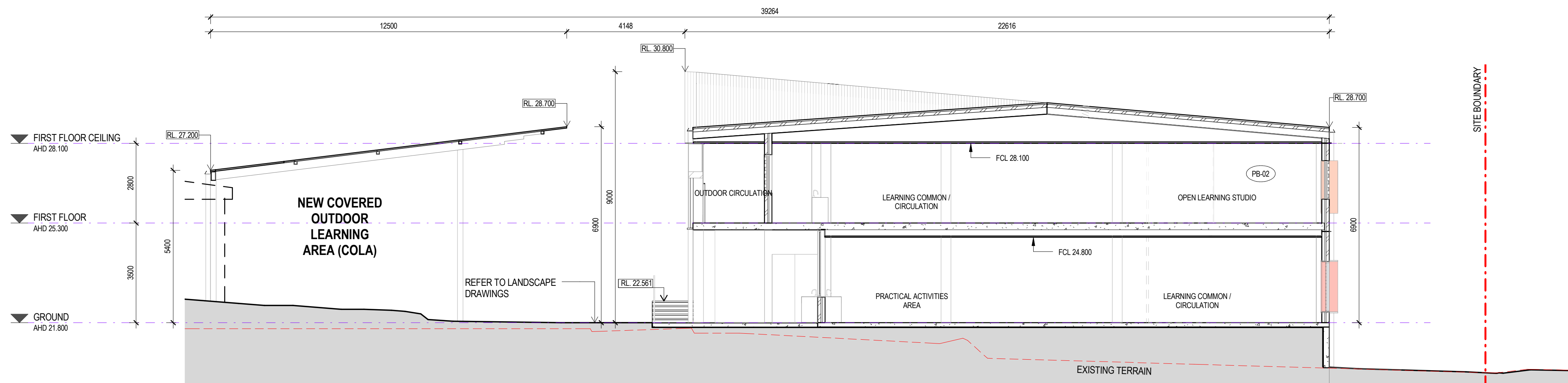

1 SECTION-1  
DA03.01 / 1:100

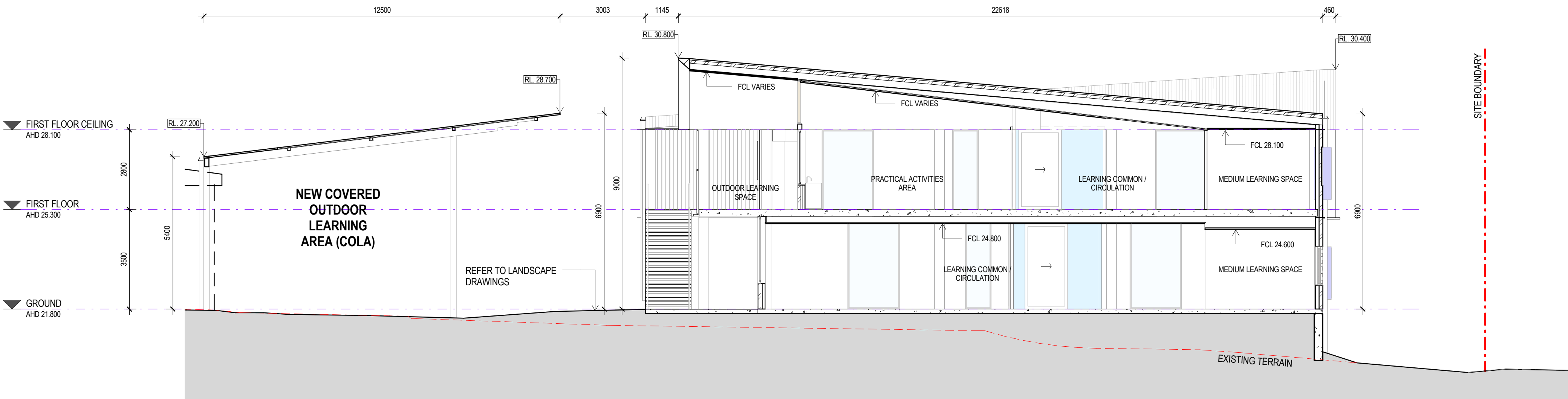

2 SECTION-2  
DA03.01 / 1:100

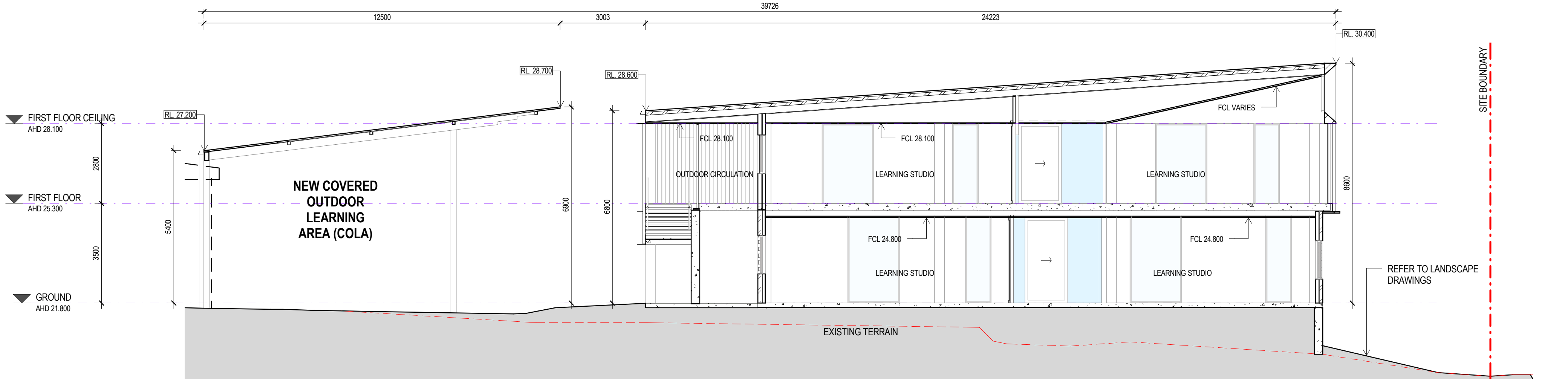

3 SECTION-3  
DA03.01 / 1:100

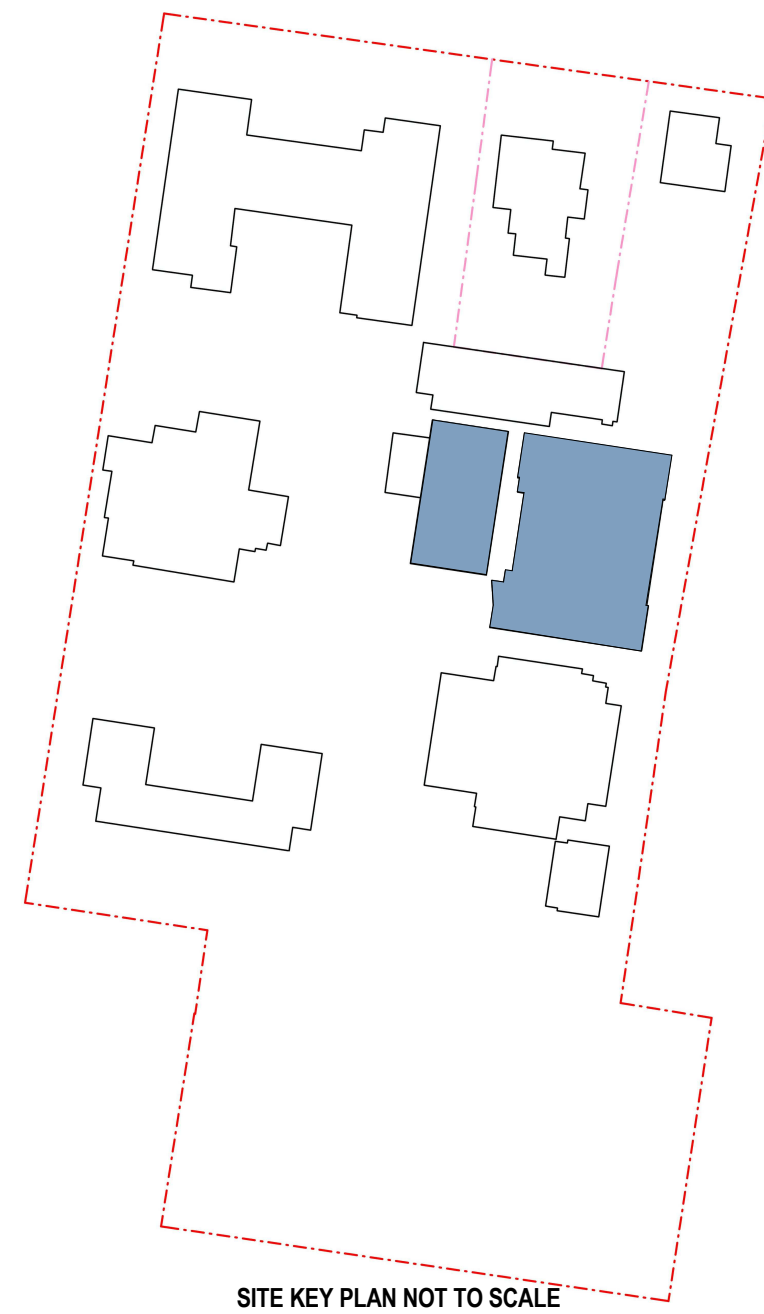

2	DEVELOPMENT APPLICATION	07.11.2017
1	DRAFT DEVELOPMENT APPLICATION	24.10.2017
Rev	Description	Date

## DEVELOPMENT APPLICATION

**hayball**

**Melbourne**  
4/135 Sturt Street Southbank, Victoria Australia 3006  
T 0+61 3 9699 3644  
www.hayball.com.au

**Sydney**  
7/1/26-32 Pirrama Road, Pyrmont NSW 2009  
T +61 2 9660 9329

**Brisbane**  
Level 12, 324 Queen Street, Brisbane Qld 4000  
T +61 7 3211 9821

**NSW Nominated Architects:**  
Tom Jordan 7521, Richard Leonard 7522, David Tordoff 8028  
ABN 84 006 394 261

Builders/Contractors shall verify job dimensions before any job commences. Figured dimensions shall take precedence over scaled work. Work shall also conform to the specification, other drawings and job dimensions. All shop drawings shall be submitted to the Architect/Consultant and modifications shall not commence prior to the return of inspected shop drawings signed by the Architect/Consultant. © Copyright 2008 All rights reserved.

Client:



**Wollongong Public School**  
BLOCK B00K  
67A Church Street, Wollongong, NSW 2500

DRAWING TITLE  
**SECTIONS**

DRAWN BY VC  
CHECKED RC  
DATE PRINTED 7/11/2017 4:07:42 PM  
SCALE 1:100@A1 1:200@A3

PROJECT NUMBER DWG NO REVISION  
**2141.10 B10.DA06.03 2**